

# Diagnostische Toets

# (A)

## VSR KMS Kwaliteitsinspectie

**A:**

- Lijsten van ruimten per categorie Blz. 2

**B:**

- Opdrachten (incl. plattegrond) Blz. 6

**Bureaunkamers**

- Tabel van willekeurige getallen (opdracht 3) Blz. 8
- Lijst van elementen Blz. 9
- Overzicht inventarisatie Blz. 10
- Tabel van willekeurige getallen (opdracht 5) Blz. 11
- Controleformulier Blz. 12

**Verkeersruimten**

- Tabel van willekeurige getallen (opdracht 7) Blz. 13
- Lijst van elementen Blz. 14
- Overzicht inventarisatie Blz. 15
- Tabel van willekeurige getallen (opdracht 9) Blz. 16
- Controleformulier Blz. 17

**Sanitair**

- Lijst van elementen Blz. 18
- Overzicht inventarisatie Blz. 19
- Tabel van willekeurige getallen (opdracht 13) Blz. 20
- Controleformulier Blz. 21

| VSR KMS    | Lijst van ruimten bij de categorie: |                    |                           |                |          |   |   |             |   |   | Bureaumurkers |             |            |                        |                           |                   |   |   |   |   |   |   |   |
|------------|-------------------------------------|--------------------|---------------------------|----------------|----------|---|---|-------------|---|---|---------------|-------------|------------|------------------------|---------------------------|-------------------|---|---|---|---|---|---|---|
| Gebouw     |                                     | Het Examen Kantoor |                           |                |          |   |   |             |   |   |               | Volgnummer  |            | 1                      |                           |                   |   |   |   |   |   |   |   |
| Inspecteur |                                     |                    |                           |                |          |   |   |             |   |   |               | KMS-Versie  |            | 3                      |                           | Vul in: 1, 2 of 3 |   |   |   |   |   |   |   |
| Datum      |                                     | 10-04-14           |                           |                | Tijdstip |   |   | 10.00-11.30 |   |   |               | Totaal SE's |            | (d) Bij methode A en B |                           |                   |   |   |   |   |   |   |   |
| Volgnummer | Ruimtecode                          | Aantal SE's        | Steekproef-inventarisatie | Datum controle |          |   |   |             |   |   |               | Volgnummer  | Ruimtecode | Aantal SE's            | Steekproef-inventarisatie | Datum controle    |   |   |   |   |   |   |   |
|            |                                     |                    |                           | 1              | 2        | 3 | 4 | 5           | 6 | 7 | 8             |             |            |                        |                           | 1                 | 2 | 3 | 4 | 5 | 6 | 7 | 8 |
| 1          | 0.05                                |                    |                           |                |          |   |   |             |   |   |               | 51          | 3.10       |                        |                           |                   |   |   |   |   |   |   |   |
| 2          | 0.17A                               |                    |                           |                |          |   |   |             |   |   |               | 52          | 3.11       |                        |                           |                   |   |   |   |   |   |   |   |
| 3          | 0.17B                               |                    |                           |                |          |   |   |             |   |   |               | 53          | 3.12       |                        |                           |                   |   |   |   |   |   |   |   |
| 4          | 0.17C                               |                    |                           |                |          |   |   |             |   |   |               | 54          | 3.16A      |                        |                           |                   |   |   |   |   |   |   |   |
| 5          | 0.17D                               |                    |                           |                |          |   |   |             |   |   |               | 55          | 3.16B      |                        |                           |                   |   |   |   |   |   |   |   |
| 6          | 0.19                                |                    |                           |                |          |   |   |             |   |   |               | 56          | 3.16C      |                        |                           |                   |   |   |   |   |   |   |   |
| 7          | 0.20                                |                    |                           |                |          |   |   |             |   |   |               | 57          | 3.16D      |                        |                           |                   |   |   |   |   |   |   |   |
| 8          | 0.21                                |                    |                           |                |          |   |   |             |   |   |               | 58          | 3.17       |                        |                           |                   |   |   |   |   |   |   |   |
| 9          | 0.23                                |                    |                           |                |          |   |   |             |   |   |               | 59          | 3.18       |                        |                           |                   |   |   |   |   |   |   |   |
| 10         | 0.24                                |                    |                           |                |          |   |   |             |   |   |               | 60          | 3.20       |                        |                           |                   |   |   |   |   |   |   |   |
| 11         | 1.04                                |                    |                           |                |          |   |   |             |   |   |               | 61          | 3.21       |                        |                           |                   |   |   |   |   |   |   |   |
| 12         | 1.05                                |                    |                           |                |          |   |   |             |   |   |               | 62          | 3.22       |                        |                           |                   |   |   |   |   |   |   |   |
| 13         | 1.08                                |                    |                           |                |          |   |   |             |   |   |               | 63          | 3.24       |                        |                           |                   |   |   |   |   |   |   |   |
| 14         | 1.09                                |                    |                           |                |          |   |   |             |   |   |               | 64          | 4.04       |                        |                           |                   |   |   |   |   |   |   |   |
| 15         | 1.10                                |                    |                           |                |          |   |   |             |   |   |               | 65          | 4.07       |                        |                           |                   |   |   |   |   |   |   |   |
| 16         | 1.11                                |                    |                           |                |          |   |   |             |   |   |               | 66          | 4.08       |                        |                           |                   |   |   |   |   |   |   |   |
| 17         | 1.12                                |                    |                           |                |          |   |   |             |   |   |               | 67          | 4.09       |                        |                           |                   |   |   |   |   |   |   |   |
| 18         | 1.16A                               |                    |                           |                |          |   |   |             |   |   |               | 68          | 4.10       |                        |                           |                   |   |   |   |   |   |   |   |
| 19         | 1.16B                               |                    |                           |                |          |   |   |             |   |   |               | 69          | 4.14A      |                        |                           |                   |   |   |   |   |   |   |   |
| 20         | 1.16C                               |                    |                           |                |          |   |   |             |   |   |               | 70          | 4.14B      |                        |                           |                   |   |   |   |   |   |   |   |
| 21         | 1.16D                               |                    |                           |                |          |   |   |             |   |   |               | 71          | 4.14C      |                        |                           |                   |   |   |   |   |   |   |   |
| 22         | 1.17                                |                    |                           |                |          |   |   |             |   |   |               | 72          | 4.14D      |                        |                           |                   |   |   |   |   |   |   |   |
| 23         | 1.18                                |                    |                           |                |          |   |   |             |   |   |               | 73          | 4.15       |                        |                           |                   |   |   |   |   |   |   |   |
| 24         | 1.20                                |                    |                           |                |          |   |   |             |   |   |               | 74          | 4.16       |                        |                           |                   |   |   |   |   |   |   |   |
| 25         | 1.21                                |                    |                           |                |          |   |   |             |   |   |               | 75          | 4.18       |                        |                           |                   |   |   |   |   |   |   |   |
| 26         | 1.22                                |                    |                           |                |          |   |   |             |   |   |               | 76          |            |                        |                           |                   |   |   |   |   |   |   |   |
| 27         | 1.24                                |                    |                           |                |          |   |   |             |   |   |               | 77          |            |                        |                           |                   |   |   |   |   |   |   |   |
| 28         | 1.25                                |                    |                           |                |          |   |   |             |   |   |               | 78          |            |                        |                           |                   |   |   |   |   |   |   |   |
| 29         | 2.04                                |                    |                           |                |          |   |   |             |   |   |               | 79          |            |                        |                           |                   |   |   |   |   |   |   |   |
| 30         | 2.05                                |                    |                           |                |          |   |   |             |   |   |               | 80          |            |                        |                           |                   |   |   |   |   |   |   |   |
| 31         | 2.08                                |                    |                           |                |          |   |   |             |   |   |               | 81          |            |                        |                           |                   |   |   |   |   |   |   |   |
| 32         | 2.09                                |                    |                           |                |          |   |   |             |   |   |               | 82          |            |                        |                           |                   |   |   |   |   |   |   |   |
| 33         | 2.10                                |                    |                           |                |          |   |   |             |   |   |               | 83          |            |                        |                           |                   |   |   |   |   |   |   |   |
| 34         | 2.11                                |                    |                           |                |          |   |   |             |   |   |               | 84          |            |                        |                           |                   |   |   |   |   |   |   |   |
| 35         | 2.12                                |                    |                           |                |          |   |   |             |   |   |               | 85          |            |                        |                           |                   |   |   |   |   |   |   |   |
| 36         | 2.16A                               |                    |                           |                |          |   |   |             |   |   |               | 86          |            |                        |                           |                   |   |   |   |   |   |   |   |
| 37         | 2.16B                               |                    |                           |                |          |   |   |             |   |   |               | 87          |            |                        |                           |                   |   |   |   |   |   |   |   |
| 38         | 2.16C                               |                    |                           |                |          |   |   |             |   |   |               | 88          |            |                        |                           |                   |   |   |   |   |   |   |   |
| 39         | 2.16D                               |                    |                           |                |          |   |   |             |   |   |               | 89          |            |                        |                           |                   |   |   |   |   |   |   |   |
| 40         | 2.17                                |                    |                           |                |          |   |   |             |   |   |               | 90          |            |                        |                           |                   |   |   |   |   |   |   |   |
| 41         | 2.18                                |                    |                           |                |          |   |   |             |   |   |               | 91          |            |                        |                           |                   |   |   |   |   |   |   |   |
| 42         | 2.20                                |                    |                           |                |          |   |   |             |   |   |               | 92          |            |                        |                           |                   |   |   |   |   |   |   |   |
| 43         | 2.21                                |                    |                           |                |          |   |   |             |   |   |               | 93          |            |                        |                           |                   |   |   |   |   |   |   |   |
| 44         | 2.22                                |                    |                           |                |          |   |   |             |   |   |               | 94          |            |                        |                           |                   |   |   |   |   |   |   |   |
| 45         | 2.24                                |                    |                           |                |          |   |   |             |   |   |               | 95          |            |                        |                           |                   |   |   |   |   |   |   |   |
| 46         | 2.25                                |                    |                           |                |          |   |   |             |   |   |               | 96          |            |                        |                           |                   |   |   |   |   |   |   |   |
| 47         | 3.04                                |                    |                           |                |          |   |   |             |   |   |               | 97          |            |                        |                           |                   |   |   |   |   |   |   |   |
| 48         | 3.05                                |                    |                           |                |          |   |   |             |   |   |               | 98          |            |                        |                           |                   |   |   |   |   |   |   |   |
| 49         | 3.08                                |                    |                           |                |          |   |   |             |   |   |               | 99          |            |                        |                           |                   |   |   |   |   |   |   |   |
| 50         | 3.09                                |                    |                           |                |          |   |   |             |   |   |               | 100         |            |                        |                           |                   |   |   |   |   |   |   |   |

| VSR KMS    |            |                    |                           |                |   |             |   |   |   | Lijst van ruimten bij de categorie: |   |                        |            |             | Verkeer                   |                |   |   |   |   |   |   |   |
|------------|------------|--------------------|---------------------------|----------------|---|-------------|---|---|---|-------------------------------------|---|------------------------|------------|-------------|---------------------------|----------------|---|---|---|---|---|---|---|
| Gebouw     |            | Het Examen Kantoor |                           |                |   |             |   |   |   | KMS-Versie                          |   | 3                      |            | Volgnummer  |                           | 1              |   |   |   |   |   |   |   |
| Inspecteur |            |                    |                           |                |   |             |   |   |   | Totaal SE's                         |   |                        |            |             |                           |                |   |   |   |   |   |   |   |
| Datum      |            | 10-04-14           |                           | Tijdstip       |   | 10.00-11.30 |   |   |   |                                     |   | (d) Bij methode A en B |            |             |                           |                |   |   |   |   |   |   |   |
| Volgnummer | Ruimtecode | Aantal SE's        | Steekproef-inventarisatie | Datum controle |   |             |   |   |   |                                     |   | Volgnummer             | Ruimtecode | Aantal SE's | Steekproef-inventarisatie | Datum controle |   |   |   |   |   |   |   |
|            |            |                    |                           | 1              | 2 | 3           | 4 | 5 | 6 | 7                                   | 8 |                        |            |             |                           | 1              | 2 | 3 | 4 | 5 | 6 | 7 | 8 |
| 1          | 0.01       | 3                  |                           |                |   |             |   |   |   |                                     |   | 51                     |            |             |                           |                |   |   |   |   |   |   |   |
| 2          | 0.02       | 2                  |                           |                |   |             |   |   |   |                                     |   | 52                     |            |             |                           |                |   |   |   |   |   |   |   |
| 3          | 0.03       | 2                  |                           |                |   |             |   |   |   |                                     |   | 53                     |            |             |                           |                |   |   |   |   |   |   |   |
| 4          | 0.04       | 2                  |                           |                |   |             |   |   |   |                                     |   | 54                     |            |             |                           |                |   |   |   |   |   |   |   |
| 5          | 0.06       | 2                  |                           |                |   |             |   |   |   |                                     |   | 55                     |            |             |                           |                |   |   |   |   |   |   |   |
| 6          | 0.17       | 2                  |                           |                |   |             |   |   |   |                                     |   | 56                     |            |             |                           |                |   |   |   |   |   |   |   |
| 7          | 0.22       | 2                  |                           |                |   |             |   |   |   |                                     |   | 57                     |            |             |                           |                |   |   |   |   |   |   |   |
| 8          | 1.01       | 3                  |                           |                |   |             |   |   |   |                                     |   | 58                     |            |             |                           |                |   |   |   |   |   |   |   |
| 9          | 1.02       | 2                  |                           |                |   |             |   |   |   |                                     |   | 59                     |            |             |                           |                |   |   |   |   |   |   |   |
| 10         | 1.03       | 2                  |                           |                |   |             |   |   |   |                                     |   | 60                     |            |             |                           |                |   |   |   |   |   |   |   |
| 11         | 1.06       | 2                  |                           |                |   |             |   |   |   |                                     |   | 61                     |            |             |                           |                |   |   |   |   |   |   |   |
| 12         | 1.07       | 2                  |                           |                |   |             |   |   |   |                                     |   | 62                     |            |             |                           |                |   |   |   |   |   |   |   |
| 13         | 1.11       | 2                  |                           |                |   |             |   |   |   |                                     |   | 63                     |            |             |                           |                |   |   |   |   |   |   |   |
| 14         | 1.23       | 2                  |                           |                |   |             |   |   |   |                                     |   | 64                     |            |             |                           |                |   |   |   |   |   |   |   |
| 15         | 2.01       | 3                  |                           |                |   |             |   |   |   |                                     |   | 65                     |            |             |                           |                |   |   |   |   |   |   |   |
| 16         | 2.02       | 2                  |                           |                |   |             |   |   |   |                                     |   | 66                     |            |             |                           |                |   |   |   |   |   |   |   |
| 17         | 2.03       | 2                  |                           |                |   |             |   |   |   |                                     |   | 67                     |            |             |                           |                |   |   |   |   |   |   |   |
| 18         | 2.06       | 2                  |                           |                |   |             |   |   |   |                                     |   | 68                     |            |             |                           |                |   |   |   |   |   |   |   |
| 19         | 2.07       | 2                  |                           |                |   |             |   |   |   |                                     |   | 69                     |            |             |                           |                |   |   |   |   |   |   |   |
| 20         | 2.11       | 2                  |                           |                |   |             |   |   |   |                                     |   | 70                     |            |             |                           |                |   |   |   |   |   |   |   |
| 21         | 2.23       | 2                  |                           |                |   |             |   |   |   |                                     |   | 71                     |            |             |                           |                |   |   |   |   |   |   |   |
| 22         | 3.01       | 3                  |                           |                |   |             |   |   |   |                                     |   | 72                     |            |             |                           |                |   |   |   |   |   |   |   |
| 23         | 3.02       | 2                  |                           |                |   |             |   |   |   |                                     |   | 73                     |            |             |                           |                |   |   |   |   |   |   |   |
| 24         | 3.03       | 2                  |                           |                |   |             |   |   |   |                                     |   | 74                     |            |             |                           |                |   |   |   |   |   |   |   |
| 25         | 3.06       | 2                  |                           |                |   |             |   |   |   |                                     |   | 75                     |            |             |                           |                |   |   |   |   |   |   |   |
| 26         | 3.07       | 2                  |                           |                |   |             |   |   |   |                                     |   | 76                     |            |             |                           |                |   |   |   |   |   |   |   |
| 27         | 3.15       | 2                  |                           |                |   |             |   |   |   |                                     |   | 77                     |            |             |                           |                |   |   |   |   |   |   |   |
| 28         | 3.19       | 2                  |                           |                |   |             |   |   |   |                                     |   | 78                     |            |             |                           |                |   |   |   |   |   |   |   |
| 29         | 3.23       | 3                  |                           |                |   |             |   |   |   |                                     |   | 79                     |            |             |                           |                |   |   |   |   |   |   |   |
| 30         | 4.01       | 3                  |                           |                |   |             |   |   |   |                                     |   | 80                     |            |             |                           |                |   |   |   |   |   |   |   |
| 31         | 4.02       | 2                  |                           |                |   |             |   |   |   |                                     |   | 81                     |            |             |                           |                |   |   |   |   |   |   |   |
| 32         | 4.03       | 2                  |                           |                |   |             |   |   |   |                                     |   | 82                     |            |             |                           |                |   |   |   |   |   |   |   |
| 33         | 4.05       | 2                  |                           |                |   |             |   |   |   |                                     |   | 83                     |            |             |                           |                |   |   |   |   |   |   |   |
| 34         | 4.06       | 2                  |                           |                |   |             |   |   |   |                                     |   | 84                     |            |             |                           |                |   |   |   |   |   |   |   |
| 35         | 4.13       | 2                  |                           |                |   |             |   |   |   |                                     |   | 85                     |            |             |                           |                |   |   |   |   |   |   |   |
| 36         | 4.17       | 2                  |                           |                |   |             |   |   |   |                                     |   | 86                     |            |             |                           |                |   |   |   |   |   |   |   |
| 37         | 4.21       | 4                  |                           |                |   |             |   |   |   |                                     |   | 87                     |            |             |                           |                |   |   |   |   |   |   |   |
| 38         |            |                    |                           |                |   |             |   |   |   |                                     |   | 88                     |            |             |                           |                |   |   |   |   |   |   |   |
| 39         |            |                    |                           |                |   |             |   |   |   |                                     |   | 89                     |            |             |                           |                |   |   |   |   |   |   |   |
| 40         |            |                    |                           |                |   |             |   |   |   |                                     |   | 90                     |            |             |                           |                |   |   |   |   |   |   |   |
| 41         |            |                    |                           |                |   |             |   |   |   |                                     |   | 91                     |            |             |                           |                |   |   |   |   |   |   |   |
| 42         |            |                    |                           |                |   |             |   |   |   |                                     |   | 92                     |            |             |                           |                |   |   |   |   |   |   |   |
| 43         |            |                    |                           |                |   |             |   |   |   |                                     |   | 93                     |            |             |                           |                |   |   |   |   |   |   |   |
| 44         |            |                    |                           |                |   |             |   |   |   |                                     |   | 94                     |            |             |                           |                |   |   |   |   |   |   |   |
| 45         |            |                    |                           |                |   |             |   |   |   |                                     |   | 95                     |            |             |                           |                |   |   |   |   |   |   |   |
| 46         |            |                    |                           |                |   |             |   |   |   |                                     |   | 96                     |            |             |                           |                |   |   |   |   |   |   |   |
| 47         |            |                    |                           |                |   |             |   |   |   |                                     |   | 97                     |            |             |                           |                |   |   |   |   |   |   |   |
| 48         |            |                    |                           |                |   |             |   |   |   |                                     |   | 98                     |            |             |                           |                |   |   |   |   |   |   |   |
| 49         |            |                    |                           |                |   |             |   |   |   |                                     |   | 99                     |            |             |                           |                |   |   |   |   |   |   |   |
| 50         |            |                    |                           |                |   |             |   |   |   |                                     |   | 100                    |            |             |                           |                |   |   |   |   |   |   |   |

| VSR KMS    |            | Lijst van ruimten bij de categorie: |                           |                |   | Sanitair    |   |                        |   |   |   |            |            |             |                           |                |   |   |   |   |   |   |   |
|------------|------------|-------------------------------------|---------------------------|----------------|---|-------------|---|------------------------|---|---|---|------------|------------|-------------|---------------------------|----------------|---|---|---|---|---|---|---|
| Gebouw     |            | Het Examen Kantoor                  |                           |                |   | Volgnummer  |   | 1                      |   |   |   |            |            |             |                           |                |   |   |   |   |   |   |   |
| Inspecteur |            |                                     |                           |                |   | KMS-Versie  |   | 3                      |   |   |   |            |            |             |                           |                |   |   |   |   |   |   |   |
| Datum      |            | 10-04-14                            |                           | Tijdstip       |   | 10.00-11.30 |   | Totaal SE's            |   |   |   |            |            |             |                           |                |   |   |   |   |   |   |   |
|            |            |                                     |                           |                |   |             |   | (d) Bij methode A en B |   |   |   |            |            |             |                           |                |   |   |   |   |   |   |   |
| Volgnummer | Ruimtecode | Aantal SE's                         | Steekproef-inventarisatie | Datum controle |   |             |   |                        |   |   |   | Volgnummer | Ruimtecode | Aantal SE's | Steekproef-inventarisatie | Datum controle |   |   |   |   |   |   |   |
|            |            |                                     |                           | 1              | 2 | 3           | 4 | 5                      | 6 | 7 | 8 |            |            |             |                           | 1              | 2 | 3 | 4 | 5 | 6 | 7 | 8 |
| 1          | 0.08       | 10                                  |                           |                |   |             |   |                        |   |   |   | 51         |            |             |                           |                |   |   |   |   |   |   |   |
| 2          | 0.11       | 5                                   |                           |                |   |             |   |                        |   |   |   | 52         |            |             |                           |                |   |   |   |   |   |   |   |
| 3          | 0.15       | 4                                   |                           |                |   |             |   |                        |   |   |   | 53         |            |             |                           |                |   |   |   |   |   |   |   |
| 4          | 0.16       | 5                                   |                           |                |   |             |   |                        |   |   |   | 54         |            |             |                           |                |   |   |   |   |   |   |   |
| 5          | 1.13       | 4                                   |                           |                |   |             |   |                        |   |   |   | 55         |            |             |                           |                |   |   |   |   |   |   |   |
| 6          | 1.14       | 5                                   |                           |                |   |             |   |                        |   |   |   | 56         |            |             |                           |                |   |   |   |   |   |   |   |
| 7          | 2.13       | 4                                   |                           |                |   |             |   |                        |   |   |   | 57         |            |             |                           |                |   |   |   |   |   |   |   |
| 8          | 2.14       | 5                                   |                           |                |   |             |   |                        |   |   |   | 58         |            |             |                           |                |   |   |   |   |   |   |   |
| 9          | 3.13       | 4                                   |                           |                |   |             |   |                        |   |   |   | 59         |            |             |                           |                |   |   |   |   |   |   |   |
| 10         | 3.14       | 5                                   |                           |                |   |             |   |                        |   |   |   | 60         |            |             |                           |                |   |   |   |   |   |   |   |
| 11         | 4.11       | 4                                   |                           |                |   |             |   |                        |   |   |   | 61         |            |             |                           |                |   |   |   |   |   |   |   |
| 12         | 4.12       | 5                                   |                           |                |   |             |   |                        |   |   |   | 62         |            |             |                           |                |   |   |   |   |   |   |   |
| 13         |            |                                     |                           |                |   |             |   |                        |   |   |   | 63         |            |             |                           |                |   |   |   |   |   |   |   |
| 14         |            |                                     |                           |                |   |             |   |                        |   |   |   | 64         |            |             |                           |                |   |   |   |   |   |   |   |
| 15         |            |                                     |                           |                |   |             |   |                        |   |   |   | 65         |            |             |                           |                |   |   |   |   |   |   |   |
| 16         |            |                                     |                           |                |   |             |   |                        |   |   |   | 66         |            |             |                           |                |   |   |   |   |   |   |   |
| 17         |            |                                     |                           |                |   |             |   |                        |   |   |   | 67         |            |             |                           |                |   |   |   |   |   |   |   |
| 18         |            |                                     |                           |                |   |             |   |                        |   |   |   | 68         |            |             |                           |                |   |   |   |   |   |   |   |
| 19         |            |                                     |                           |                |   |             |   |                        |   |   |   | 69         |            |             |                           |                |   |   |   |   |   |   |   |
| 20         |            |                                     |                           |                |   |             |   |                        |   |   |   | 70         |            |             |                           |                |   |   |   |   |   |   |   |
| 21         |            |                                     |                           |                |   |             |   |                        |   |   |   | 71         |            |             |                           |                |   |   |   |   |   |   |   |
| 22         |            |                                     |                           |                |   |             |   |                        |   |   |   | 72         |            |             |                           |                |   |   |   |   |   |   |   |
| 23         |            |                                     |                           |                |   |             |   |                        |   |   |   | 73         |            |             |                           |                |   |   |   |   |   |   |   |
| 24         |            |                                     |                           |                |   |             |   |                        |   |   |   | 74         |            |             |                           |                |   |   |   |   |   |   |   |
| 25         |            |                                     |                           |                |   |             |   |                        |   |   |   | 75         |            |             |                           |                |   |   |   |   |   |   |   |
| 26         |            |                                     |                           |                |   |             |   |                        |   |   |   | 76         |            |             |                           |                |   |   |   |   |   |   |   |
| 27         |            |                                     |                           |                |   |             |   |                        |   |   |   | 77         |            |             |                           |                |   |   |   |   |   |   |   |
| 28         |            |                                     |                           |                |   |             |   |                        |   |   |   | 78         |            |             |                           |                |   |   |   |   |   |   |   |
| 29         |            |                                     |                           |                |   |             |   |                        |   |   |   | 79         |            |             |                           |                |   |   |   |   |   |   |   |
| 30         |            |                                     |                           |                |   |             |   |                        |   |   |   | 80         |            |             |                           |                |   |   |   |   |   |   |   |
| 31         |            |                                     |                           |                |   |             |   |                        |   |   |   | 81         |            |             |                           |                |   |   |   |   |   |   |   |
| 32         |            |                                     |                           |                |   |             |   |                        |   |   |   | 82         |            |             |                           |                |   |   |   |   |   |   |   |
| 33         |            |                                     |                           |                |   |             |   |                        |   |   |   | 83         |            |             |                           |                |   |   |   |   |   |   |   |
| 34         |            |                                     |                           |                |   |             |   |                        |   |   |   | 84         |            |             |                           |                |   |   |   |   |   |   |   |
| 35         |            |                                     |                           |                |   |             |   |                        |   |   |   | 85         |            |             |                           |                |   |   |   |   |   |   |   |
| 36         |            |                                     |                           |                |   |             |   |                        |   |   |   | 86         |            |             |                           |                |   |   |   |   |   |   |   |
| 37         |            |                                     |                           |                |   |             |   |                        |   |   |   | 87         |            |             |                           |                |   |   |   |   |   |   |   |
| 38         |            |                                     |                           |                |   |             |   |                        |   |   |   | 88         |            |             |                           |                |   |   |   |   |   |   |   |
| 39         |            |                                     |                           |                |   |             |   |                        |   |   |   | 89         |            |             |                           |                |   |   |   |   |   |   |   |
| 40         |            |                                     |                           |                |   |             |   |                        |   |   |   | 90         |            |             |                           |                |   |   |   |   |   |   |   |
| 41         |            |                                     |                           |                |   |             |   |                        |   |   |   | 91         |            |             |                           |                |   |   |   |   |   |   |   |
| 42         |            |                                     |                           |                |   |             |   |                        |   |   |   | 92         |            |             |                           |                |   |   |   |   |   |   |   |
| 43         |            |                                     |                           |                |   |             |   |                        |   |   |   | 93         |            |             |                           |                |   |   |   |   |   |   |   |
| 44         |            |                                     |                           |                |   |             |   |                        |   |   |   | 94         |            |             |                           |                |   |   |   |   |   |   |   |
| 45         |            |                                     |                           |                |   |             |   |                        |   |   |   | 95         |            |             |                           |                |   |   |   |   |   |   |   |
| 46         |            |                                     |                           |                |   |             |   |                        |   |   |   | 96         |            |             |                           |                |   |   |   |   |   |   |   |
| 47         |            |                                     |                           |                |   |             |   |                        |   |   |   | 97         |            |             |                           |                |   |   |   |   |   |   |   |
| 48         |            |                                     |                           |                |   |             |   |                        |   |   |   | 98         |            |             |                           |                |   |   |   |   |   |   |   |
| 49         |            |                                     |                           |                |   |             |   |                        |   |   |   | 99         |            |             |                           |                |   |   |   |   |   |   |   |
| 50         |            |                                     |                           |                |   |             |   |                        |   |   |   | 100        |            |             |                           |                |   |   |   |   |   |   |   |

# Diagnostische Toets

# (B)

## VSR KMS Kwaliteitsinspectie

**A:**

- Lijsten van ruimten per categorie Blz. 2

**B:**

- Opdrachten (incl. plattegrond) Blz. 6

**Bureaumurkers**

- Tabel van willekeurige getallen (opdracht 3) Blz. 8
- Lijst van elementen Blz. 9
- Overzicht inventarisatie Blz. 10
- Tabel van willekeurige getallen (opdracht 5) Blz. 11
- Controleformulier Blz. 12

**Verkeersruimten**

- Tabel van willekeurige getallen (opdracht 7) Blz. 13
- Lijst van elementen Blz. 14
- Overzicht inventarisatie Blz. 15
- Tabel van willekeurige getallen (opdracht 9) Blz. 16
- Controleformulier Blz. 17

**Sanitair**

- Lijst van elementen Blz. 18
- Overzicht inventarisatie Blz. 19
- Tabel van willekeurige getallen (opdracht 13) Blz. 20
- Controleformulier Blz. 21

**Opdracht 1.**

Plaats een kruis in alle ruimten die niet binnen de schoonmaak vallen.  
Deze zijn gemarkeerd met **G.S.** (geen schoonmaak).

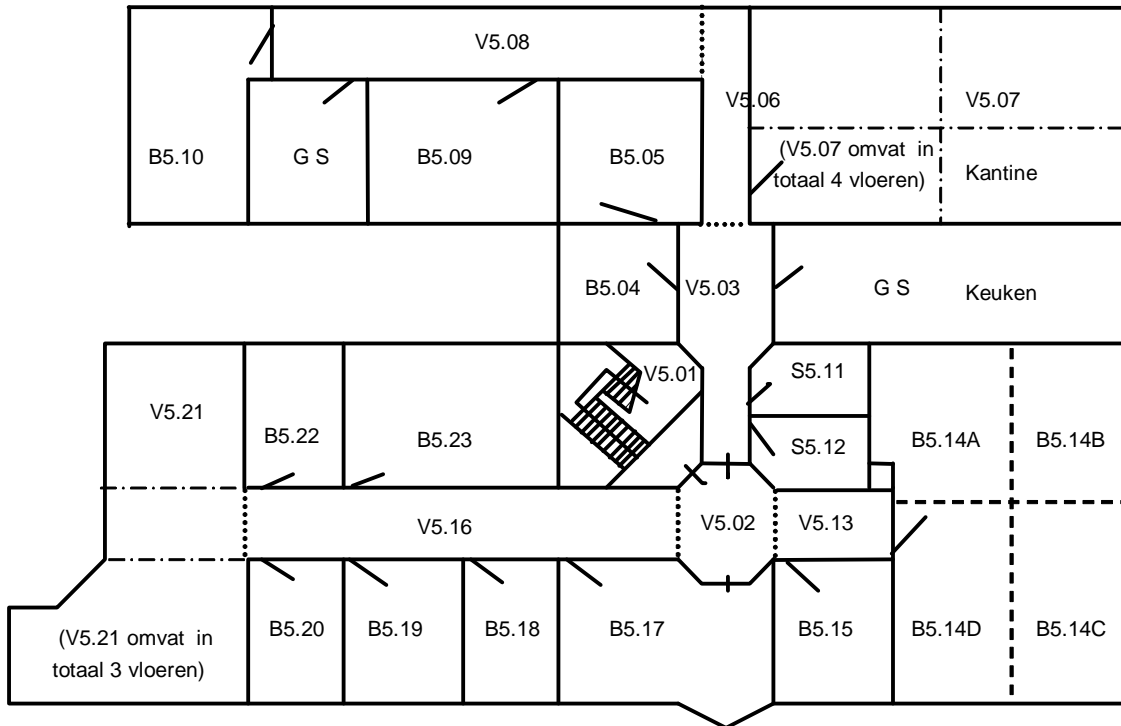
**Ter informatie:**

Elke gang of gangdeel dat op de tekening als afzonderlijk deel is aangegeven met deuren of stippellijnen is één vloer groot. Zoals op de tekening is aangegeven, is de wacht- / pauzeruimte drie vloeren groot en is de kantine vier vloeren groot.

Het sanitair op de vijfde verdieping is qua inrichting gelijk aan het sanitair op de eerste tot de vierde verdieping.

Er is een trap naar het dak die maandelijks binnen de schoonmaak valt.

Er worden per jaar 4 controles gepland. De gehanteerde AQL's zijn standaard: Bureaukamers en Verkeersruimten op 7%, Sanitair op 4%.

**Opdracht 2**

Completeer de 'Lijsten van ruimten' voor de verschillende ruimtecategorieën (Bureau, Verkeer en Sanitair) met de ruimten die U in opdracht 1 gevonden heeft.

**Opdracht 3**

Stel de steekproef voor inventarisatie samen voor de categorie Bureaukamers.

Doe dit met behulp van de betreffende 'Lijst van ruimten' uit opdracht 2 en de tabel van willekeurige getallen op blz. 8. (Begin bij getal 87 in het vierkantje.) Laat de systematiek zien op dit vel!

**Opdracht 4**

Completeer de 'Lijst van elementen' en het 'Inventarisatie overzicht' voor de categorie Bureaukamers met alle noodzakelijke informatie. Vul op de 'Lijst van elementen' de geselecteerde ruimten in.

Houdt er rekening mee dat gedurende de inventarisatie er vier bureaurooms in tweeën gesplitst moesten worden, vanwege het aantal werkplekken.

**Opdracht 5**

Stel de steekproef voor controle samen voor de categorie Bureaukamers.

Doe dit met behulp van de betreffende 'Lijst van ruimten' uit opdracht 2 en de tabel van willekeurige getallen op blz. 11. (Begin bij getal 43 in het vierkantje.) Laat de systematiek zien op dit vel!

*N.B. De controle wordt uitgevoerd op het niveau van de normale keuring.*

**Opdracht 6**

Completeer het controleformulier Bureaukamers met alle benodigde informatie.

Vul op het formulier ook de ruimtes in zoals gevonden in opdracht 5.

*Na afloop van de controle is de werkelijke steekproefgrootte drie steekprofeenheden groter dan de minimale steekproefgrootte.*

**Opdracht 7**

Stel de steekproef voor inventarisatie samen voor de categorie Verkeersruimten.

Doe dit met behulp van de betreffende 'Lijst van ruimten' uit opdracht 2 en de tabel van willekeurige getallen op blz. 13. (Begin bij getal 62 in het vierkantje.) Laat de systematiek zien op dit vel!

Vul de 'Lijst van elementen' voor de categorie Verkeersruimten zo volledig mogelijk in, inclusief de geselecteerde ruimten.

**Opdracht 8**

Completeer het 'Inventarisatie overzicht' voor de categorie Verkeersruimten met alle noodzakelijke informatie.

**Opdracht 9**

Stel de steekproef voor controle samen voor de categorie Verkeersruimten.

Doe dit met behulp van de betreffende 'Lijst van ruimten' uit opdracht 2 en de tabel van willekeurige getallen op blz. 16. (Begin bij getal 01 in het vierkantje.) Laat de systematiek zien op dit vel!

*N.B. De controle wordt uitgevoerd op het niveau van de normale keuring.*

**Opdracht 10**

Completeer het controleformulier Verkeersruimten met alle benodigde informatie.

Vul op het formulier ook de ruimtes in zoals gevonden in opdracht 8.

**Opdracht 11:**

Vul de 'Lijst van elementen' voor de categorie Sanitair zo volledig mogelijk in.

**Opdracht 12**

Completeer het 'Inventarisatie overzicht' voor de categorie Sanitair met alle noodzakelijke informatie.

**Opdracht 13**

Stel de steekproef voor controle samen voor de categorie Sanitair.

Doe dit met behulp van de betreffende 'Lijst van ruimten' uit opdracht 2 en de tabel van willekeurige getallen op blz. 20. (Begin bij getal 93 in het vierkantje.) Laat de systematiek zien op dit vel!

*N.B. De controle wordt uitgevoerd op het niveau van de normale keuring.*

**Opdracht 14**

Completeer het controleformulier Sanitair met alle benodigde informatie.

Vul op het formulier ook de ruimtes in zoals gevonden in opdracht 13.

**(hoort bij opdracht 3: inventarisatie - Bureaukamers)**

Begin bij getal 87 in het vierkantje! Let wel dit is de eerste ruimte van de steekproefselectie!

Tabel van willekeurige getallen

Annex E

|                |                       |                |                |                |
|----------------|-----------------------|----------------|----------------|----------------|
| 99 55 96 83 31 | 62 53 52 41 70        | 69 77 71 28 30 | 74 81 97 81 42 | 43 86 07 28 34 |
| 77 51 30 38 20 | 86 83 42 99 01        | 68 41 48 27 74 | 51 90 31 39 80 | 72 29 35 55 07 |
| 19 50 23 71 74 | 69 97 92 02 88        | 55 21 02 97 73 | 74 28 77 52 51 | 65 34 46 74 15 |
| 21 81 85 93 13 | 93 27 88 17 57        | 05 63 67 31 56 | 07 08 28 50 46 | 31 85 33 84 52 |
| 51 47 46 64 99 | 68 10 72 36 21        | 94 04 99 13 45 | 42 83 60 91 91 | 08 00 74 54 49 |
| 33 71 34 80 07 | 93 58 47 28 69        | 51 92 66 47 21 | 58 30 32 98 22 | 93 17 49 39 72 |
| 85 27 48 68 93 | 11 30 32 92 70        | 28 83 43 41 37 | 78 51 59 04 00 | 71 14 84 36 43 |
| 84 13 38 96 40 | 44 03 55 21 66        | 73 85 27 00 91 | 61 22 26 05 61 | 62 32 71 84 23 |
| 65 73 21 62 34 | 17 39 59 61 31        | 10 12 39 16 22 | 85 49 65 75 60 | 81 60 41 88 80 |
| 56 13 85 68 06 | 87 64 88 52 61        | 34 31 36 58 61 | 45 87 52 10 69 | 85 64 44 72 77 |
| 38 00 10 21 76 | 81 71 91 17 11        | 71 60 29 29 37 | 74 21 96 49 49 | 65 58 44 96 98 |
| 37 40 29 63 97 | 01 30 47 75 86        | 56 27 11 00 86 | 47 32 46 26 02 | 40 03 03 74 38 |
| 97 12 45 03 48 | <b>87</b> 08 33 14 17 | 21 81 53 92 50 | 75 23 76 20 47 | 15 50 12 95 78 |
| 21 63 34 11 62 | 47 14 33 40 72        | 64 63 88 59 02 | 49 13 90 64 41 | 03 85 65 45 52 |
| 73 13 54 27 42 | 95 71 90 90 35        | 85 79 47 42 96 | 08 78 98 81 56 | 64 69 11 92 02 |
| 07 63 87 79 29 | 03 06 11 80 72        | 96 20 74 41 56 | 23 82 19 95 38 | 04 71 36 69 94 |
| 60 52 88 34 41 | 07 95 41 98 14        | 59 17 52 06 95 | 05 53 35 21 39 | 61 21 20 64 55 |
| 83 59 63 56 55 | 06 95 89 29 83        | 05 12 80 97 19 | 77 43 35 37 83 | 92 30 15 04 98 |
| 10 85 06 27 46 | 99 59 91 05 07        | 13 49 90 63 19 | 53 07 57 18 39 | 06 41 01 93 62 |
| 39 82 09 89 52 | 43 62 26 31 47        | 64 42 18 08 14 | 43 80 00 93 51 | 31 02 47 31 67 |
| 59 58 00 64 78 | 75 56 97 88 00        | 88 83 55 44 86 | 23 76 80 61 56 | 04 11 10 84 08 |
| 38 50 80 73 41 | 23 79 34 87 63        | 90 82 29 70 22 | 17 71 90 42 07 | 95 95 44 99 53 |
| 30 69 27 06 68 | 94 68 81 61 27        | 56 19 68 00 91 | 82 06 76 34 00 | 05 46 26 92 00 |
| 65 44 39 56 59 | 18 28 82 74 37        | 49 63 22 40 41 | 08 33 76 56 76 | 96 29 99 08 36 |
| 27 26 75 02 64 | 13 19 27 22 94        | 07 47 74 46 06 | 17 98 54 89 11 | 97 34 13 03 58 |
| 91 30 90 70 69 | 91 19 07 22 42        | 10 36 69 95 37 | 28 28 82 53 57 | 93 28 97 66 62 |
| 68 43 49 46 88 | 84 47 31 36 22        | 62 12 09 84 08 | 12 84 38 25 90 | 09 81 59 31 46 |
| 48 90 81 58 77 | 54 74 52 45 91        | 35 70 00 47 54 | 83 82 45 26 92 | 54 13 05 51 60 |
| 06 91 34 51 97 | 42 67 27 86 01        | 11 88 30 95 28 | 63 01 19 89 01 | 14 97 44 03 44 |
| 10 45 51 60 19 | 14 21 03 37 12        | 91 34 23 78 21 | 88 32 58 08 51 | 43 66 77 08 83 |
| 12 88 39 73 43 | 65 02 76 11 84        | 04 28 50 13 92 | 17 97 41 50 77 | 90 71 22 67 69 |
| 21 77 83 09 76 | 38 80 73 69 61        | 31 64 94 20 96 | 63 28 10 20 23 | 08 81 64 74 49 |
| 19 52 35 95 15 | 65 12 25 96 59        | 86 28 36 82 58 | 69 57 21 37 98 | 16 43 59 15 29 |
| 67 24 55 26 70 | 35 58 31 65 63        | 79 24 68 66 86 | 76 46 33 42 22 | 26 65 59 08 02 |
| 60 58 44 73 77 | 07 50 03 79 92        | 45 13 42 65 29 | 26 76 08 36 37 | 41 32 64 43 44 |
| 53 85 34 13 77 | 36 06 69 48 50        | 58 83 87 38 59 | 49 36 47 33 31 | 96 24 04 36 42 |
| 24 63 73 87 36 | 74 38 48 93 42        | 52 62 30 79 92 | 12 36 91 86 01 | 03 74 28 38 73 |
| 83 08 01 24 51 | 38 99 22 28 15        | 07 75 95 17 77 | 97 37 72 75 85 | 51 97 23 78 67 |
| 16 44 42 43 34 | 36 15 19 90 73        | 27 49 37 09 39 | 85 13 03 25 52 | 54 84 65 47 59 |
| 60 79 01 81 57 | 57 17 86 57 62        | 11 16 17 85 76 | 45 81 95 29 79 | 65 13 00 48 30 |



| VSR KMS               |  |                |                |  |  |            | Lijst van elementen bij de categorie: <b>Bureaukamers</b> |  |  |
|-----------------------|--|----------------|----------------|--|--|------------|---|--|--|
| Gebouw                | Het Examen Kantoor   |                |                |  |  | Volgnummer | 1   |  |  |
| Datum                 | 10-04-14   | Tijdstip       | 10.00 - 11.30  |  |  | KMS-Versie | 3   |  |  |
| Inspecteur            |  |                |                |  |  |            | Vul in:<br>1, 2 of 3                                      |  |  |
| te inventariseren (x) | Ruimtecodes steekproef - Methode B incl. de SE's - Methode C/D incl. eventuele splitsing |                |                |  |  |            | SE's  |  |  |
|                       |  |                |                |  |  |            | Ruimten   |  |  |
|                       |  |                |                |  |  |            |   |  |  |
|                       |  |                |                |  |  |            |   |  |  |
|                       |  |                |                |  |  |            | Totaal  |  |  |
|                       | <b>Element:</b>  | <b>Totaal:</b> | <b>Aantal:</b> |  |  |            |   |  |  |
| X                     | Afvalbak / Prullenbak  |                |                |  |  |            |   |  |  |
| X                     | Armatuur / Bureau lamp   |                |                |  |  |            |   |  |  |
|                       | Bad binnenzijde / Badgarnituur   |                |                |  |  |            |   |  |  |
|                       | Bad buitenzijde  |                |                |  |  |            |   |  |  |
|                       | Badtrap  |                |                |  |  |            |   |  |  |
|                       | Bank   |                |                |  |  |            |   |  |  |
|                       | Balie, Bar   |                |                |  |  |            |   |  |  |
|                       | Bassinrand   |                |                |  |  |            |   |  |  |
|                       | Bedieningspaneel   |                |                |  |  |            |   |  |  |
|                       | Behandelbed  |                |                |  |  |            |   |  |  |
| X                     | Bijzettafel  |                |                |  |  |            |   |  |  |
|                       | Borstelhouder  |                |                |  |  |            |   |  |  |
|                       | Brandblusapparaat  |                |                |  |  |            |   |  |  |
|                       | Brildekautomaat  |                |                |  |  |            |   |  |  |
| X                     | Bureau / Tafel   |                |                |  |  |            |   |  |  |
| X                     | Deur / Deurpost  |                |                |  |  |            |   |  |  |
|                       | Doorspoelinstallatie   |                |                |  |  |            |   |  |  |
|                       | <b>Douche- / Natte vloer</b>   |                |                |  |  |            |   |  |  |
|                       | Douche-installatie   |                |                |  |  |            |   |  |  |
|                       | Douchewand   |                |                |  |  |            |   |  |  |
|                       | Gordijnrail  |                |                |  |  |            |   |  |  |
|                       | Handdoekhouder / Handdoekautomaat  |                |                |  |  |            |   |  |  |
|                       | Hygiënezakhouder   |                |                |  |  |            |   |  |  |
| X                     | Kapstok  |                |                |  |  |            |   |  |  |
| X                     | Kast (hoog)  |                |                |  |  |            |   |  |  |
|                       | Kast (inbouw)  |                |                |  |  |            |   |  |  |
| X                     | Kast (laag)  |                |                |  |  |            |   |  |  |
|                       | Keukenblok / Aanrecht  |                |                |  |  |            |   |  |  |
|                       | Klimrek  |                |                |  |  |            |   |  |  |
|                       | Koffie automaat  |                |                |  |  |            |   |  |  |
|                       | Leiding / Buis   |                |                |  |  |            |   |  |  |
|                       | Leuning  |                |                |  |  |            |   |  |  |
|                       | Pedaalemmer  |                |                |  |  |            |   |  |  |
|                       | Planchet   |                |                |  |  |            |   |  |  |
|                       | Plint / Kabelgoot  |                |                |  |  |            |   |  |  |
| X                     | Radiator / Convectorkast   |                |                |  |  |            |   |  |  |
|                       | Rand / Richel  |                |                |  |  |            |   |  |  |
| X                     | Schakelaar / Contactdoos   | (1)            |                |  |  |            |   |  |  |
|                       | Schoolbord   |                |                |  |  |            |   |  |  |
|                       | Spiegel  |                |                |  |  |            |   |  |  |
| X                     | Stoel / Kruk   |                |                |  |  |            |   |  |  |
| X                     | Telefoon   |                |                |  |  |            |   |  |  |
|                       | Toiletbril   |                |                |  |  |            |   |  |  |
|                       | Toiletpapierautomaat   |                |                |  |  |            |   |  |  |
|                       | <b>Toiletpot / Slokop</b>  |                |                |  |  |            |   |  |  |
|                       | Toiletrolhouder  |                |                |  |  |            |   |  |  |
|                       | Tussenschot / Schaamschot  |                |                |  |  |            |   |  |  |
|                       | <b>Urinoir</b>   |                |                |  |  |            |   |  |  |
| X                     | Vensterbank  |                |                |  |  |            |   |  |  |
|                       | Verbandautomaat  |                |                |  |  |            |   |  |  |
| X                     | <b>Vloer / Trap</b>  |                |                |  |  |            |   |  |  |
|                       | Wand   |                |                |  |  |            |   |  |  |
|                       | <b>Wastafel</b>  |                |                |  |  |            |   |  |  |
|                       | Zeepdispenser  |                |                |  |  |            |   |  |  |
|                       |  |                |                |  |  |            |   |  |  |
|                       |  |                |                |  |  |            |   |  |  |
|                       |  |                |                |  |  |            |   |  |  |
|                       |  |                |                |  |  |            |   |  |  |
|                       |  |                |                |  |  |            |   |  |  |
|                       |  |                |                |  |  |            |   |  |  |
|                       | <b>Totaal elementen</b>  |                | <b>(e)</b>     |  |  |            |   |  |  |

(1) Bij bureaunkamers 2-maal het aantal vloeren

**VSR KMS Inventarisatie overzicht per categorie: Bureaukamers**

|            |                    |            |   |
|------------|--------------------|------------|---|
| Gebouw     | Het Examen Kantoor |            |   |
| Datum      | 10-04-14           | KMS-Versie | 3 |
| Inspecteur | Vul in: 1, 2 of 3  |            |   |

|                        |        |
|------------------------|--------|
| Inventarisatie methode | Type = |
|------------------------|--------|

A = 100% --- B = deelsteekproef --- C = selecte steekproef --- D = aselechte steekproef

**Totaal aantal ruimten:** (zie: lijst van ruimten)

**Aantal ruimten in de inventarisatie**  
 Methode A: het totale aantal ruimten = a, **OF**   
 Methode B/C/D: het aantal ruimten in de inventarisatie (zie: lijst van elementen)

**Aantal SE's in de inventarisatie** (zie: lijst van elementen)

**Totaal aantal steekprofeenheden:**  
 Methode A / B het totale aantal SE's **OF** (zie: lijst van ruimten)   
 Methode C / D SE's in inventarisatie x  $\frac{\text{Totaal aantal ruimten}}{\text{Ruimten in steekproef}}$   $\frac{c \times a}{b}$

**Aantal elementen in de inventarisatie:** (zie: lijst van elementen)

**MAF-waarde:**  $\frac{\text{aantal elementen in inventarisatie}}{\text{aantal SE's in inventarisatie}}$   $\frac{e}{c}$   (1)

**AQL (Acceptance Quality Limit)**

**Aantal geplande controles per jaar** (i.v.m. het grijze gebied)  (2)

**Minimaal aantal te controleren Beoordelingseenheden (SE's):** m n s  (3)

m.b.v. totaal aantal SE's (d) opzoeken in de steekproefgrootte-tabel

Alleen methode C en D:

**Gemiddeld aantal beoordelingseenheden per ruimte:**  
 $\frac{\text{totaal aantal SE's}}{\text{totaal aantal ruimten}}$   $\frac{d}{a}$   (3)

**Minimaal aantal te controleren ruimten:**  
 $\frac{\text{Steekproefgrootte in SE's}}{\text{aantal SE's per ruimte}}$   $\frac{i}{j}$  m n s  (4)

De steekproefgrootten (m / n / s : verminderd, normaal, verscherpt) voor de controle, uitgedrukt in minimum aantal te controleren SE's (i) en eventueel ook in minimum aantal ruimten (k) is nu bekend.

- (1) Statistisch afronden. Groter of gelijk aan 3,50 op hele getallen, kleiner tot op één cijfer achter de komma.
- (2) Bij schema's met een lage keuringsfrequentie moet men buiten het grijze gebied blijven.
- (3) Afronden tot twee cijfers achter de komma
- (4) Afronden naar boven op hele getallen

**(hoort bij opdracht 5: controle - Bureaukamers)**

Begin bij getal 43 in het vierkantje!

Tabel van willekeurige getallen

Annex E

|                |                |                |                       |                |
|----------------|----------------|----------------|-----------------------|----------------|
| 99 55 96 83 31 | 62 53 52 41 70 | 69 77 71 28 30 | 74 81 97 81 42        | 43 86 07 28 34 |
| 77 51 30 38 20 | 86 83 42 99 01 | 68 41 48 27 74 | 51 90 31 39 80        | 72 29 35 55 07 |
| 19 50 23 71 74 | 69 97 92 02 88 | 55 21 02 97 73 | 74 28 77 52 51        | 65 34 46 74 15 |
| 21 81 85 93 13 | 93 27 88 17 57 | 05 63 67 31 56 | 07 08 28 50 46        | 31 85 33 84 52 |
| 51 47 46 64 99 | 68 10 72 36 21 | 94 04 99 13 45 | 42 83 60 91 91        | 08 00 74 54 49 |
| 33 71 34 80 07 | 93 58 47 28 69 | 51 92 66 47 21 | 58 30 32 98 22        | 93 17 49 39 72 |
| 85 27 48 68 93 | 11 30 32 92 70 | 28 83 43 41 37 | 78 51 59 04 00        | 71 14 84 36 43 |
| 84 13 38 96 40 | 44 03 55 21 66 | 73 85 27 00 91 | 61 22 26 05 61        | 62 32 71 84 23 |
| 65 73 21 62 34 | 17 39 59 61 31 | 10 12 39 16 22 | 85 49 65 75 60        | 81 60 41 88 80 |
| 56 13 85 68 06 | 87 64 88 52 61 | 34 31 36 58 61 | 45 87 52 10 69        | 85 64 44 72 77 |
| 38 00 10 21 76 | 81 71 91 17 11 | 71 60 29 29 37 | 74 21 96 49 49        | 65 58 44 96 98 |
| 37 40 29 63 97 | 01 30 47 75 86 | 56 27 11 00 86 | 47 32 46 26 02        | 40 03 03 74 38 |
| 97 12 45 03 48 | 87 08 33 14 17 | 21 81 53 92 50 | 75 23 76 20 47        | 15 50 12 95 78 |
| 21 63 34 11 62 | 47 14 33 40 72 | 64 63 88 59 02 | 49 13 90 64 41        | 03 85 65 45 52 |
| 73 13 54 27 42 | 95 71 90 90 35 | 85 79 47 42 96 | 08 78 98 81 56        | 64 69 11 92 02 |
| 07 63 87 79 29 | 03 06 11 80 72 | 96 20 74 41 56 | 23 82 19 95 38        | 04 71 36 69 94 |
| 60 52 88 34 41 | 07 95 41 98 14 | 59 17 52 06 95 | 05 53 35 21 39        | 61 21 20 64 55 |
| 83 59 63 56 55 | 06 95 89 29 83 | 05 12 80 97 19 | 77 43 35 37 83        | 92 30 15 04 98 |
| 10 85 06 27 46 | 99 59 91 05 07 | 13 49 90 63 19 | 53 07 57 18 39        | 06 41 01 93 62 |
| 39 82 09 89 52 | 43 62 26 31 47 | 64 42 18 08 14 | <b>43</b> 80 00 93 51 | 31 02 47 31 67 |
| 59 58 00 64 78 | 75 56 97 88 00 | 88 83 55 44 86 | 23 76 80 61 56        | 04 11 10 84 08 |
| 38 50 80 73 41 | 23 79 34 87 63 | 90 82 29 70 22 | 17 71 90 42 07        | 95 95 44 99 53 |
| 30 69 27 06 68 | 94 68 81 61 27 | 56 19 68 00 91 | 82 06 76 34 00        | 05 46 26 92 00 |
| 65 44 39 56 59 | 18 28 82 74 37 | 49 63 22 40 41 | 08 33 76 56 76        | 96 29 99 08 36 |
| 27 26 75 02 64 | 13 19 27 22 94 | 07 47 74 46 06 | 17 98 54 89 11        | 97 34 13 03 58 |
| 91 30 90 70 69 | 91 19 07 22 42 | 10 36 69 95 37 | 28 28 82 53 57        | 93 28 97 66 62 |
| 68 43 49 46 88 | 84 47 31 36 22 | 62 12 09 84 08 | 12 84 38 25 90        | 09 81 59 31 46 |
| 48 90 81 58 77 | 54 74 52 45 91 | 35 70 00 47 54 | 83 82 45 26 92        | 54 13 05 51 60 |
| 06 91 34 51 97 | 42 67 27 86 01 | 11 88 30 95 28 | 63 01 19 89 01        | 14 97 44 03 44 |
| 10 45 51 60 19 | 14 21 03 37 12 | 91 34 23 78 21 | 88 32 58 08 51        | 43 66 77 08 83 |
| 12 88 39 73 43 | 65 02 76 11 84 | 04 28 50 13 92 | 17 97 41 50 77        | 90 71 22 67 69 |
| 21 77 83 09 76 | 38 80 73 69 61 | 31 64 94 20 96 | 63 28 10 20 23        | 08 81 64 74 49 |
| 19 52 35 95 15 | 65 12 25 96 59 | 86 28 36 82 58 | 69 57 21 37 98        | 16 43 59 15 29 |
| 67 24 55 26 70 | 35 58 31 65 63 | 79 24 68 66 86 | 76 46 33 42 22        | 26 65 59 08 02 |
| 60 58 44 73 77 | 07 50 03 79 92 | 45 13 42 65 29 | 26 76 08 36 37        | 41 32 64 43 44 |
| 53 85 34 13 77 | 36 06 69 48 50 | 58 83 87 38 59 | 49 36 47 33 31        | 96 24 04 36 42 |
| 24 63 73 87 36 | 74 38 48 93 42 | 52 62 30 79 92 | 12 36 91 86 01        | 03 74 28 38 73 |
| 83 08 01 24 51 | 38 99 22 28 15 | 07 75 95 17 77 | 97 37 72 75 85        | 51 97 23 78 67 |
| 16 44 42 43 34 | 36 15 19 90 73 | 27 49 37 09 39 | 85 13 03 25 52        | 54 84 65 47 59 |
| 60 79 01 81 57 | 57 17 86 57 62 | 11 16 17 85 76 | 45 81 95 29 79        | 65 13 00 48 30 |

**VSR KMS** **Controleformulier bij de categorie:**

|            |                   |           |          |                      |     |                             |                    |
|------------|-------------------|-----------|----------|----------------------|-----|-----------------------------|--------------------|
| Gebouw     | Het Examenkantoor |           |          |                      |     | Volgnummer                  |                    |
| Inspecteur |                   |           |          |                      |     | Minimale steekproefgrootte: | KMS-Versie (1/2/3) |
| Datum      | 27-05-14          | Tijdstip  | 7.00 uur | in SE's              | (i) | AQL %                       |                    |
| Goedkeur ≤ |                   | Resultaat | goedkeur | in kamers            | (k) | MAF-Waarde                  | (f)                |
| Fouten     |                   |           | afkeur   | (Bij methode C en D) |     | Steekproefgrootte           |                    |

|                                |  |  |  |  |  |  |  |  |  |  |  |
|--------------------------------|--|--|--|--|--|--|--|--|--|--|--|
| Ruimtecodes en aantallen SE's. |  |  |  |  |  |  |  |  |  |  |  |
|                                |  |  |  |  |  |  |  |  |  |  |  |
|                                |  |  |  |  |  |  |  |  |  |  |  |
|                                |  |  |  |  |  |  |  |  |  |  |  |
|                                |  |  |  |  |  |  |  |  |  |  |  |
|                                |  |  |  |  |  |  |  |  |  |  |  |

|   |                                | Niet gehecht vuil |         |            | Gehecht vuil      |         |          | Diversen | Materiaal | Bijzonderheden |
|---|--------------------------------|-------------------|---------|------------|-------------------|---------|----------|----------|-----------|----------------|
|   |                                | Licht stof        |         | Dicht stof | Vlek/Vingertasten |         | Aan-slag |          |           |                |
|   |                                | Vuil              | Methode |            | Vuil              | Methode |          |          |           |                |
| X | Afvalbak / Prullenbak          |                   |         |            |                   | ///     |          |          |           |                |
| X | Armatuur / Bureauilamp         |                   |         |            |                   |         |          |          |           |                |
|   | Bad binnenzijde / Badgarnituur |                   |         |            |                   |         |          |          |           |                |
|   | Bad buitenzijde                |                   |         |            |                   |         |          |          |           |                |
|   | Badtrap                        |                   |         |            |                   |         |          |          |           |                |
|   | Bank                           |                   |         |            |                   |         |          |          |           |                |
|   | Balie, Bar                     |                   |         |            |                   |         |          |          |           |                |
|   | Bassinrand                     |                   |         |            |                   |         |          |          |           |                |
|   | Bedieningspaneel               |                   |         |            |                   |         |          |          |           |                |
|   | Behandelbed                    |                   |         |            |                   |         |          |          |           |                |
| X | Bijzettafel                    |                   |         |            |                   |         |          |          |           |                |
|   | Borstelhouder                  |                   |         |            |                   |         |          |          |           |                |
|   | Brandblusapparaat              |                   |         |            |                   |         |          |          |           |                |
|   | Briidekautomaat                |                   |         |            |                   |         |          |          |           |                |
| X | Bureau / Tafel                 |                   |         |            | /                 |         |          |          |           |                |
| X | Deur / Deurpost                |                   |         |            |                   | ///     |          |          |           |                |
|   | Doorspoelininstallatie         |                   |         |            |                   |         |          |          |           |                |
|   | <b>Douche- / Natte vloer</b>   |                   |         |            |                   |         |          |          |           |                |
|   | Douche-installatie             |                   |         |            |                   |         |          |          |           |                |
|   | Douchewand                     |                   |         |            |                   |         |          |          |           |                |
|   | Gordijnrail                    |                   |         |            |                   |         |          |          |           |                |
|   | Handdoekhouder / Handdoekautor |                   |         |            |                   |         |          |          |           |                |
|   | Hygiënezakhouder               |                   |         |            |                   |         |          |          |           |                |
| X | Kapstok                        |                   |         |            |                   |         |          |          |           |                |
| X | Kast (hoog)                    | /                 |         |            |                   | ///     |          |          |           |                |
|   | Kast (inbouw)                  |                   |         |            |                   |         |          |          |           |                |
| X | Kast (laag)                    | /                 |         |            |                   | ///     |          |          |           |                |
|   | Keukenblok / Aanrecht          |                   |         |            |                   |         |          |          |           |                |
|   | Klimrek                        |                   |         |            |                   |         |          |          |           |                |
|   | Koffie automaat                |                   |         |            |                   |         |          |          |           |                |
|   | Leiding / Buis                 |                   |         |            |                   |         |          |          |           |                |
|   | Leuning                        |                   |         |            |                   |         |          |          |           |                |
|   | Pedaalemmer                    |                   |         |            |                   |         |          |          |           |                |
|   | Planchet                       |                   |         |            |                   |         |          |          |           |                |
|   | Plint / Kabelgoot              |                   |         |            |                   |         |          |          |           |                |
| X | Radiator / Convectorkast       |                   |         |            |                   |         |          |          |           |                |
|   | Rand / Richel                  |                   |         |            |                   |         |          |          |           |                |
| X | Schakelaar / Contactdoos       | ///               |         |            |                   |         |          |          |           |                |
|   | Schoolbord                     |                   |         |            |                   |         |          |          |           |                |
|   | Spiegel                        |                   |         |            |                   |         |          |          |           |                |
| X | Stoel / Kruk                   |                   |         |            |                   |         |          |          |           |                |
| X | Telefoon                       |                   |         |            |                   | /       |          |          |           |                |
|   | Toiletbril                     |                   |         |            |                   |         |          |          |           |                |
|   | Toiletpapierautomaat           |                   |         |            |                   |         |          |          |           |                |
|   | <b>Toiletpot / Slokop</b>      |                   |         |            |                   |         |          |          |           |                |
|   | Toiletrolhouder                |                   |         |            |                   |         |          |          |           |                |
|   | Tussenschot / Schaamschot      |                   |         |            |                   |         |          |          |           |                |
|   | <b>Urinoir</b>                 |                   |         |            |                   |         |          |          |           |                |
| X | Vensterbank                    |                   |         |            |                   |         |          |          |           |                |
|   | Verbandautomaat                |                   |         |            |                   |         |          |          |           |                |
| X | <b>Vloer / Trap</b>            |                   |         |            |                   |         |          |          |           |                |
|   | Wand                           |                   |         |            |                   |         |          |          |           |                |
|   | <b>Wastafel</b>                |                   |         |            |                   |         |          |          |           |                |
|   | Zeepdispenser                  |                   |         |            |                   |         |          |          |           |                |
|   |                                |                   |         |            |                   |         |          |          |           |                |
|   |                                |                   |         |            |                   |         |          |          |           |                |
|   |                                |                   |         |            |                   |         |          |          |           |                |
|   |                                |                   |         |            |                   |         |          |          |           |                |
|   |                                |                   |         |            |                   |         |          |          |           |                |
|   | <b>Totaal:</b>                 |                   |         |            |                   |         |          |          |           |                |

Opmerkingen:

**(hoort bij opdracht 7: inventarisatie - Verkeersruimten)**

Begin bij getal 62 in het vierkantje!

Tabel van willekeurige getallen

Annex E

|                       |                |                |                |                |
|-----------------------|----------------|----------------|----------------|----------------|
| 99 55 96 83 31        | 62 53 52 41 70 | 69 77 71 28 30 | 74 81 97 81 42 | 43 86 07 28 34 |
| 77 51 30 38 20        | 86 83 42 99 01 | 68 41 48 27 74 | 51 90 31 39 80 | 72 29 35 55 07 |
| 19 50 23 71 74        | 69 97 92 02 88 | 55 21 02 97 73 | 74 28 77 52 51 | 65 34 46 74 15 |
| 21 81 85 93 13        | 93 27 88 17 57 | 05 63 67 31 56 | 07 08 28 50 46 | 31 85 33 84 52 |
| 51 47 46 64 99        | 68 10 72 36 21 | 94 04 99 13 45 | 42 83 60 91 91 | 08 00 74 54 49 |
| 33 71 34 80 07        | 93 58 47 28 69 | 51 92 66 47 21 | 58 30 32 98 22 | 93 17 49 39 72 |
| 85 27 48 68 93        | 11 30 32 92 70 | 28 83 43 41 37 | 78 51 59 04 00 | 71 14 84 36 43 |
| 84 13 38 96 40        | 44 03 55 21 66 | 73 85 27 00 91 | 61 22 26 05 61 | 62 32 71 84 23 |
| 65 73 21 62 34        | 17 39 59 61 31 | 10 12 39 16 22 | 85 49 65 75 60 | 81 60 41 88 80 |
| 56 13 85 68 06        | 87 64 88 52 61 | 34 31 36 58 61 | 45 87 52 10 69 | 85 64 44 72 77 |
| 38 00 10 21 76        | 81 71 91 17 11 | 71 60 29 29 37 | 74 21 96 49 49 | 65 58 44 96 98 |
| 37 40 29 63 97        | 01 30 47 75 86 | 56 27 11 00 86 | 47 32 46 26 02 | 40 03 03 74 38 |
| 97 12 45 03 48        | 87 08 33 14 17 | 21 81 53 92 50 | 75 23 76 20 47 | 15 50 12 95 78 |
| 21 63 34 11 <b>62</b> | 47 14 33 40 72 | 64 63 88 59 02 | 49 13 90 64 41 | 03 85 65 45 52 |
| 73 13 54 27 42        | 95 71 90 90 35 | 85 79 47 42 96 | 08 78 98 81 56 | 64 69 11 92 02 |
| 07 63 87 79 29        | 03 06 11 80 72 | 96 20 74 41 56 | 23 82 19 95 38 | 04 71 36 69 94 |
| 60 52 88 34 41        | 07 95 41 98 14 | 59 17 52 06 95 | 05 53 35 21 39 | 61 21 20 64 55 |
| 83 59 63 56 55        | 06 95 89 29 83 | 05 12 80 97 19 | 77 43 35 37 83 | 92 30 15 04 98 |
| 10 85 06 27 46        | 99 59 91 05 07 | 13 49 90 63 19 | 53 07 57 18 39 | 06 41 01 93 62 |
| 39 82 09 89 52        | 43 62 26 31 47 | 64 42 18 08 14 | 43 80 00 93 51 | 31 02 47 31 67 |
| 59 58 00 64 78        | 75 56 97 88 00 | 88 83 55 44 86 | 23 76 80 61 56 | 04 11 10 84 08 |
| 38 50 80 73 41        | 23 79 34 87 63 | 90 82 29 70 22 | 17 71 90 42 07 | 95 95 44 99 53 |
| 30 69 27 06 68        | 94 68 81 61 27 | 56 19 68 00 91 | 82 06 76 34 00 | 05 46 26 92 00 |
| 65 44 39 56 59        | 18 28 82 74 37 | 49 63 22 40 41 | 08 33 76 56 76 | 96 29 99 08 36 |
| 27 26 75 02 64        | 13 19 27 22 94 | 07 47 74 46 06 | 17 98 54 89 11 | 97 34 13 03 58 |
| 91 30 90 70 69        | 91 19 07 22 42 | 10 36 69 95 37 | 28 28 82 53 57 | 93 28 97 66 62 |
| 68 43 49 46 88        | 84 47 31 36 22 | 62 12 09 84 08 | 12 84 38 25 90 | 09 81 59 31 46 |
| 48 90 81 58 77        | 54 74 52 45 91 | 35 70 00 47 54 | 83 82 45 26 92 | 54 13 05 51 60 |
| 06 91 34 51 97        | 42 67 27 86 01 | 11 88 30 95 28 | 63 01 19 89 01 | 14 97 44 03 44 |
| 10 45 51 60 19        | 14 21 03 37 12 | 91 34 23 78 21 | 88 32 58 08 51 | 43 66 77 08 83 |
| 12 88 39 73 43        | 65 02 76 11 84 | 04 28 50 13 92 | 17 97 41 50 77 | 90 71 22 67 69 |
| 21 77 83 09 76        | 38 80 73 69 61 | 31 64 94 20 96 | 63 28 10 20 23 | 08 81 64 74 49 |
| 19 52 35 95 15        | 65 12 25 96 59 | 86 28 36 82 58 | 69 57 21 37 98 | 16 43 59 15 29 |
| 67 24 55 26 70        | 35 58 31 65 63 | 79 24 68 66 86 | 76 46 33 42 22 | 26 65 59 08 02 |
| 60 58 44 73 77        | 07 50 03 79 92 | 45 13 42 65 29 | 26 76 08 36 37 | 41 32 64 43 44 |
| 53 85 34 13 77        | 36 06 69 48 50 | 58 83 87 38 59 | 49 36 47 33 31 | 96 24 04 36 42 |
| 24 63 73 87 36        | 74 38 48 93 42 | 52 62 30 79 92 | 12 36 91 86 01 | 03 74 28 38 73 |
| 83 08 01 24 51        | 38 99 22 28 15 | 07 75 95 17 77 | 97 37 72 75 85 | 51 97 23 78 67 |
| 16 44 42 43 34        | 36 15 19 90 73 | 27 49 37 09 39 | 85 13 03 25 52 | 54 84 65 47 59 |
| 60 79 01 81 57        | 57 17 86 57 62 | 11 16 17 85 76 | 45 81 95 29 79 | 65 13 00 48 30 |

| <b>VSR KMS</b>                      |  |                    |                |          | <b>Lijst van elementen bij de categorie: Verkeer</b>            |               |        |            |                      |
|-------------------------------------|--|--------------------|----------------|----------|---|---------------|--------|------------|----------------------|
| Gebouw                              |  | Het Examen Kantoor |                |          | Volgnummer  |               | 1      |            |                      |
| Datum                               |  | 10-05-05           |                | Tijdstip |   | 10.00 - 11.30 |        | KMS-Versie |                      |
| Inspecteur                          |  |                    |                |          | KMS-Versie  |               | 3      |            | Vul in:<br>1, 2 of 3 |
| te inventariseren (x)               | Ruimtecodes steekproef - Methode B incl. de SE's - Methode C/D incl. eventuele splitsing |                    |                |          |   |               |        | SE's       |                      |
|                                     |  |                    |                |          |   |               |        | Ruimten    |                      |
|                                     |  |                    |                |          |   |               |        |            |                      |
|                                     |  |                    |                |          |   |               |        | (b)        |                      |
|                                     |  |                    |                |          |   |               | Totaal |            | (c)                  |
| <b>Element:</b>                     |  |                    | <b>Totaal:</b> |          | <b>Aantal:</b>  |               |        |            |                      |
| <input checked="" type="checkbox"/> | Afvalbak / Prullenbak  |                    |                |          | <del>###</del> I  |               |        |            |                      |
| <input checked="" type="checkbox"/> | Armatuur / Bureau lamp   |                    |                |          | III   |               |        |            |                      |
|                                     | Bad binnenzijde / Badgarnituur   |                    |                |          |   |               |        |            |                      |
|                                     | Bad buitenzijde  |                    |                |          |   |               |        |            |                      |
|                                     | Badtrap  |                    |                |          |   |               |        |            |                      |
|                                     | Bank   |                    |                |          |   |               |        |            |                      |
|                                     | Balie, Bar   |                    |                |          |   |               |        |            |                      |
|                                     | Bassinrand   |                    |                |          |   |               |        |            |                      |
|                                     | Bedieningspaneel   |                    |                |          |   |               |        |            |                      |
|                                     | Behandelbed  |                    |                |          |   |               |        |            |                      |
| <input checked="" type="checkbox"/> | Bijzettafel  |                    |                |          | II  |               |        |            |                      |
|                                     | Borstelhouder  |                    |                |          |   |               |        |            |                      |
| <input checked="" type="checkbox"/> | Brandblusapparaat  |                    |                |          | II  |               |        |            |                      |
|                                     | Brildekautomaat  |                    |                |          |   |               |        |            |                      |
| <input checked="" type="checkbox"/> | Bureau / Tafel   |                    |                |          |   |               |        |            |                      |
| <input checked="" type="checkbox"/> | Deur / Deurpost  |                    |                |          | <del>###</del> <del>###</del> <del>###</del> III                |               |        |            |                      |
|                                     | Doorspoelinstallatie   |                    |                |          |   |               |        |            |                      |
|                                     | <b>Douche- / Natte vloer</b>   |                    |                |          |   |               |        |            |                      |
|                                     | Douche-installatie   |                    |                |          |   |               |        |            |                      |
|                                     | Douchewand   |                    |                |          |   |               |        |            |                      |
|                                     | Gordijnrail  |                    |                |          |   |               |        |            |                      |
|                                     | Handdoekhouder / Handdoekautomaat  |                    |                |          |   |               |        |            |                      |
|                                     | Hygienezakhouder   |                    |                |          |   |               |        |            |                      |
| <input checked="" type="checkbox"/> | Kapstok  |                    |                |          | III   |               |        |            |                      |
| <input checked="" type="checkbox"/> | Kast (hoog)  |                    |                |          | <del>###</del> I  |               |        |            |                      |
|                                     | Kast (inbouw)  |                    |                |          |   |               |        |            |                      |
| <input checked="" type="checkbox"/> | Kast (laag)  |                    |                |          |   |               |        |            |                      |
|                                     | Keukenblok / Aanrecht  |                    |                |          |   |               |        |            |                      |
|                                     | Klimrek  |                    |                |          |   |               |        |            |                      |
|                                     | Koffie automaat  |                    |                |          |   |               |        |            |                      |
|                                     | Leiding / Buis   |                    |                |          |   |               |        |            |                      |
|                                     | Leuning  |                    |                |          |   |               |        |            |                      |
|                                     | Pedaalemmer  |                    |                |          |   |               |        |            |                      |
|                                     | Planchet   |                    |                |          |   |               |        |            |                      |
|                                     | Plint / Kabelgoot  |                    |                |          |   |               |        |            |                      |
| <input checked="" type="checkbox"/> | Radiator / Convectorkast   |                    |                |          | <del>###</del> I  |               |        |            |                      |
|                                     | Rand / Richel  |                    |                |          |   |               |        |            |                      |
| <input checked="" type="checkbox"/> | Schakelaar / Contactdoos   |                    | (1)            |          | <del>###</del> <del>###</del> <del>###</del> III                |               |        |            |                      |
|                                     | Schoolbord   |                    |                |          |   |               |        |            |                      |
|                                     | Spiegel  |                    |                |          |   |               |        |            |                      |
| <input checked="" type="checkbox"/> | Stoel / Kruk   |                    |                |          | <del>###</del> II   |               |        |            |                      |
| <input checked="" type="checkbox"/> | Telefoon   |                    |                |          | III   |               |        |            |                      |
|                                     | Toiletbril   |                    |                |          |   |               |        |            |                      |
|                                     | Toiletpapierautomaat   |                    |                |          |   |               |        |            |                      |
|                                     | <b>Toiletpot / Slokop</b>  |                    |                |          |   |               |        |            |                      |
|                                     | Toiletrolhouder  |                    |                |          |   |               |        |            |                      |
|                                     | Tussenschot / Schaamschot  |                    |                |          |   |               |        |            |                      |
|                                     | <b>Urinoir</b>   |                    |                |          |   |               |        |            |                      |
| <input checked="" type="checkbox"/> | Vensterbank  |                    |                |          | <del>###</del> III  |               |        |            |                      |
|                                     | Verbandautomaat  |                    |                |          |   |               |        |            |                      |
| <input checked="" type="checkbox"/> | <b>Vloer / Trap</b>  |                    |                |          | <del>###</del> <del>###</del> <del>###</del> <del>###</del> III |               |        |            |                      |
|                                     | Wand   |                    |                |          |   |               |        |            |                      |
|                                     | <b>Wastafel</b>  |                    |                |          |   |               |        |            |                      |
|                                     | Zeepdispenser  |                    |                |          |   |               |        |            |                      |
|                                     |  |                    |                |          |   |               |        |            |                      |
|                                     |  |                    |                |          |   |               |        |            |                      |
|                                     |  |                    |                |          |   |               |        |            |                      |
|                                     |  |                    |                |          |   |               |        |            |                      |
|                                     | <b>Totaal elementen</b>  |                    |                |          | (e)   |               |        |            |                      |

(1) Bij bureukamers 2-maal het aantal vloeren

**VSR KMS Inventarisatie overzicht per categorie: Verkeer**

|            |                    |            |   |
|------------|--------------------|------------|---|
| Gebouw     | Het Examen Kantoor |            |   |
| Datum      | 10-04-14           | KMS-Versie | 3 |
| Inspecteur | Vul in: 1, 2 of 3  |            |   |

|   |        |
|---|--------|
| Inventarisatie methode  | Type = |
| A = 100% --- B = deelsteekproef --- C = selecte steekproef --- D = aselechte steekproef |        |

|  |  |                        |                            |
|--|--|------------------------|----------------------------|
| <b>Totaal aantal ruimten:</b>  | (zie: lijst van ruimten)   | <input type="text"/>   | a                          |
| <b>Aantal ruimten in de inventarisatie</b>                           |  |                        |                            |
| Methode A: het totale aantal ruimten                                 | = a, <b>OF</b>   | <input type="text"/>   | b                          |
| Methode B/C/D: het aantal ruimten in de inventarisatie               | (zie: lijst van elementen)   | <input type="text"/>   |                            |
| <b>Aantal SE's in de inventarisatie</b>                              | (zie: lijst van elementen)   | <input type="text"/>   | c                          |
| <b>Totaal aantal steekprofeenheden:</b>                              |  |                        |                            |
| Methode A / B het totale aantal SE's                                 | <b>OF</b> (zie: lijst van ruimten)   | <input type="text"/>   | d                          |
| Methode C / D SE's in inventarisatie                                 | x $\frac{\text{Totaal aantal ruimten}}{\text{Ruimten in steekproef}}$                    | $\frac{c \times a}{b}$ |                            |
| <b>Aantal elementen in de inventarisatie:</b>                        | (zie: lijst van elementen)   | <input type="text"/>   | e                          |
| <b>MAF-waarde:</b>   | $\frac{\text{aantal elementen in inventarisatie}}{\text{aantal SE's in inventarisatie}}$ | $\frac{e}{c}$          | <input type="text"/> f (1) |
| <b>AQL (Acceptance Quality Limit)</b>                                |  | <input type="text"/>   | g                          |
| <b>Aantal geplande controles per jaar (i.v.m. het grijze gebied)</b> |  | <input type="text"/>   | h (2)                      |
| <b>Minimaal aantal te controleren Beoordelingseenheden (SE's):</b>   |  | <input type="text"/>   |                            |
| m.b.v. totaal aantal SE's (d) opzoeken in de steekproefgrootte-tabel |  | <input type="text"/>   | <input type="text"/>       |

Alleen methode C en D:

|  |  |               |                      |                      |
|--|--|---------------|----------------------|----------------------|
| <b>Gemiddeld aantal beoordelingseenheden per ruimte:</b> | $\frac{\text{totaal aantal SE's}}{\text{totaal aantal ruimten}}$         | $\frac{d}{a}$ | <input type="text"/> | j (3)                |
| <b>Minimaal aantal te controleren ruimten:</b>           | $\frac{\text{Steekproefgrootte in SE's}}{\text{aantal SE's per ruimte}}$ | $\frac{i}{j}$ | <input type="text"/> | <input type="text"/> |
|  |  |               | <input type="text"/> | <input type="text"/> |
|  |  |               | <input type="text"/> | k (4)                |

De steekproefgrootten (m / n / s : verminderd, normaal, verscherpt) voor de controle, uitgedrukt in minimum aantal te controleren SE's (i) en eventueel ook in minimum aantal ruimten (k) is nu bekend.

(1) Statistisch afronden. Groter of gelijk aan 3,50 op hele getallen, kleiner tot op één cijfer achter de komma.  
 (2) Bij schema's met een lage keuringsfrequentie moet men buiten het grijze gebied blijven.  
 (3) Afronden tot twee cijfers achter de komma  
 (4) Afronden naar boven op hele getallen

**(hoort bij opdracht 9: controle - Verkeersruimten)**

Begin bij getal 01 in het vierkantje!

Tabel van willekeurige getallen

Annex E

|                |                       |                |                |                |
|----------------|-----------------------|----------------|----------------|----------------|
| 99 55 96 83 31 | 62 53 52 41 70        | 69 77 71 28 30 | 74 81 97 81 42 | 43 86 07 28 34 |
| 77 51 30 38 20 | 86 83 42 99 01        | 68 41 48 27 74 | 51 90 31 39 80 | 72 29 35 55 07 |
| 19 50 23 71 74 | 69 97 92 02 88        | 55 21 02 97 73 | 74 28 77 52 51 | 65 34 46 74 15 |
| 21 81 85 93 13 | 93 27 88 17 57        | 05 63 67 31 56 | 07 08 28 50 46 | 31 85 33 84 52 |
| 51 47 46 64 99 | 68 10 72 36 21        | 94 04 99 13 45 | 42 83 60 91 91 | 08 00 74 54 49 |
| 33 71 34 80 07 | 93 58 47 28 69        | 51 92 66 47 21 | 58 30 32 98 22 | 93 17 49 39 72 |
| 85 27 48 68 93 | 11 30 32 92 70        | 28 83 43 41 37 | 78 51 59 04 00 | 71 14 84 36 43 |
| 84 13 38 96 40 | 44 03 55 21 66        | 73 85 27 00 91 | 61 22 26 05 61 | 62 32 71 84 23 |
| 65 73 21 62 34 | 17 39 59 61 31        | 10 12 39 16 22 | 85 49 65 75 60 | 81 60 41 88 80 |
| 56 13 85 68 06 | 87 64 88 52 61        | 34 31 36 58 61 | 45 87 52 10 69 | 85 64 44 72 77 |
| 38 00 10 21 76 | 81 71 91 17 11        | 71 60 29 29 37 | 74 21 96 49 49 | 65 58 44 96 98 |
| 37 40 29 63 97 | 01 30 47 75 86        | 56 27 11 00 86 | 47 32 46 26 02 | 40 03 03 74 38 |
| 97 12 45 03 48 | 87 08 33 14 17        | 21 81 53 92 50 | 75 23 76 20 47 | 15 50 12 95 78 |
| 21 63 34 11 62 | 47 14 33 40 72        | 64 63 88 59 02 | 49 13 90 64 41 | 03 85 65 45 52 |
| 73 13 54 27 42 | 95 71 90 90 35        | 85 79 47 42 96 | 08 78 98 81 56 | 64 69 11 92 02 |
| 07 63 87 79 29 | 03 06 11 80 72        | 96 20 74 41 56 | 23 82 19 95 38 | 04 71 36 69 94 |
| 60 52 88 34 41 | 07 95 41 98 14        | 59 17 52 06 95 | 05 53 35 21 39 | 61 21 20 64 55 |
| 83 59 63 56 55 | 06 95 89 29 83        | 05 12 80 97 19 | 77 43 35 37 83 | 92 30 15 04 98 |
| 10 85 06 27 46 | 99 59 91 05 07        | 13 49 90 63 19 | 53 07 57 18 39 | 06 41 01 93 62 |
| 39 82 09 89 52 | 43 62 26 31 47        | 64 42 18 08 14 | 43 80 00 93 51 | 31 02 47 31 67 |
| 59 58 00 64 78 | 75 56 97 88 00        | 88 83 55 44 86 | 23 76 80 61 56 | 04 11 10 84 08 |
| 38 50 80 73 41 | 23 79 34 87 63        | 90 82 29 70 22 | 17 71 90 42 07 | 95 95 44 99 53 |
| 30 69 27 06 68 | 94 68 81 61 27        | 56 19 68 00 91 | 82 06 76 34 00 | 05 46 26 92 00 |
| 65 44 39 56 59 | 18 28 82 74 37        | 49 63 22 40 41 | 08 33 76 56 76 | 96 29 99 08 36 |
| 27 26 75 02 64 | 13 19 27 22 94        | 07 47 74 46 06 | 17 98 54 89 11 | 97 34 13 03 58 |
| 91 30 90 70 69 | 91 19 07 22 42        | 10 36 69 95 37 | 28 28 82 53 57 | 93 28 97 66 62 |
| 68 43 49 46 88 | 84 47 31 36 22        | 62 12 09 84 08 | 12 84 38 25 90 | 09 81 59 31 46 |
| 48 90 81 58 77 | 54 74 52 45 91        | 35 70 00 47 54 | 83 82 45 26 92 | 54 13 05 51 60 |
| 06 91 34 51 97 | 42 67 27 86 <b>01</b> | 11 88 30 95 28 | 63 01 19 89 01 | 14 97 44 03 44 |
| 10 45 51 60 19 | 14 21 03 37 12        | 91 34 23 78 21 | 88 32 58 08 51 | 43 66 77 08 83 |
| 12 88 39 73 43 | 65 02 76 11 84        | 04 28 50 13 92 | 17 97 41 50 77 | 90 71 22 67 69 |
| 21 77 83 09 76 | 38 80 73 69 61        | 31 64 94 20 96 | 63 28 10 20 23 | 08 81 64 74 49 |
| 19 52 35 95 15 | 65 12 25 96 59        | 86 28 36 82 58 | 69 57 21 37 98 | 16 43 59 15 29 |
| 67 24 55 26 70 | 35 58 31 65 63        | 79 24 68 66 86 | 76 46 33 42 22 | 26 65 59 08 02 |
| 60 58 44 73 77 | 07 50 03 79 92        | 45 13 42 65 29 | 26 76 08 36 37 | 41 32 64 43 44 |
| 53 85 34 13 77 | 36 06 69 48 50        | 58 83 87 38 59 | 49 36 47 33 31 | 96 24 04 36 42 |
| 24 63 73 87 36 | 74 38 48 93 42        | 52 62 30 79 92 | 12 36 91 86 01 | 03 74 28 38 73 |
| 83 08 01 24 51 | 38 99 22 28 15        | 07 75 95 17 77 | 97 37 72 75 85 | 51 97 23 78 67 |
| 16 44 42 43 34 | 36 15 19 90 73        | 27 49 37 09 39 | 85 13 03 25 52 | 54 84 65 47 59 |
| 60 79 01 81 57 | 57 17 86 57 62        | 11 16 17 85 76 | 45 81 95 29 79 | 65 13 00 48 30 |



| VSR KMS  |                           |                   |         |            |                   |          |              |                      |  | Controleformulier bij de categorie: |  |          |           |                   |                    |  |  |  |  |  |  |  |  |  |  |  |  |  |  |  |  |  |  |  |  |  |  |  |  |  |  |  |  |  |  |  |  |  |  |  |  |  |  |  |  |  |  |  |  |  |  |  |  |  |  |  |  |  |  |  |  |  |  |  |  |  |  |  |  |  |  |  |  |  |  |  |  |  |  |  |  |  |  |  |  |  |  |  |  |
|--|---------------------------|-------------------|---------|------------|-------------------|----------|--------------|----------------------|--|-------------------------------------|--|----------|-----------|-------------------|--------------------|--|--|--|--|--|--|--|--|--|--|--|--|--|--|--|--|--|--|--|--|--|--|--|--|--|--|--|--|--|--|--|--|--|--|--|--|--|--|--|--|--|--|--|--|--|--|--|--|--|--|--|--|--|--|--|--|--|--|--|--|--|--|--|--|--|--|--|--|--|--|--|--|--|--|--|--|--|--|--|--|--|--|--|--|
| Gebouw   |                           |                   |         |            | Het Examenkantoor |          |              |                      |  | Volgnummer                          |  |          |           |                   |                    |  |  |  |  |  |  |  |  |  |  |  |  |  |  |  |  |  |  |  |  |  |  |  |  |  |  |  |  |  |  |  |  |  |  |  |  |  |  |  |  |  |  |  |  |  |  |  |  |  |  |  |  |  |  |  |  |  |  |  |  |  |  |  |  |  |  |  |  |  |  |  |  |  |  |  |  |  |  |  |  |  |  |  |  |
| Inspecteur   |                           |                   |         |            |                   |          |              |                      |  | Minimale steekproefgrootte:         |  |          |           |                   | KMS-Versie (1/2/3) |  |  |  |  |  |  |  |  |  |  |  |  |  |  |  |  |  |  |  |  |  |  |  |  |  |  |  |  |  |  |  |  |  |  |  |  |  |  |  |  |  |  |  |  |  |  |  |  |  |  |  |  |  |  |  |  |  |  |  |  |  |  |  |  |  |  |  |  |  |  |  |  |  |  |  |  |  |  |  |  |  |  |  |  |
| Datum  |                           | 27-05-14          |         | Tijdstip   |                   | 7.00 uur |              | in SE's              |  |                                     |  | (i)      |           | AQL %             |                    |  |  |  |  |  |  |  |  |  |  |  |  |  |  |  |  |  |  |  |  |  |  |  |  |  |  |  |  |  |  |  |  |  |  |  |  |  |  |  |  |  |  |  |  |  |  |  |  |  |  |  |  |  |  |  |  |  |  |  |  |  |  |  |  |  |  |  |  |  |  |  |  |  |  |  |  |  |  |  |  |  |  |  |  |
| Goedkeur ≤   |                           |                   |         | Resultaat  |                   | goedkeur |              | in kamers            |  |                                     |  | (k)      |           | MAF-Waarde (f)    |                    |  |  |  |  |  |  |  |  |  |  |  |  |  |  |  |  |  |  |  |  |  |  |  |  |  |  |  |  |  |  |  |  |  |  |  |  |  |  |  |  |  |  |  |  |  |  |  |  |  |  |  |  |  |  |  |  |  |  |  |  |  |  |  |  |  |  |  |  |  |  |  |  |  |  |  |  |  |  |  |  |  |  |  |  |
| Fouten   |                           |                   |         |            |                   | afkeur   |              | (Bij methode C en D) |  |                                     |  |          |           | Steekproefgrootte |                    |  |  |  |  |  |  |  |  |  |  |  |  |  |  |  |  |  |  |  |  |  |  |  |  |  |  |  |  |  |  |  |  |  |  |  |  |  |  |  |  |  |  |  |  |  |  |  |  |  |  |  |  |  |  |  |  |  |  |  |  |  |  |  |  |  |  |  |  |  |  |  |  |  |  |  |  |  |  |  |  |  |  |  |  |
| Ruimtecodes en aantallen SE's.   |                           |                   |         |            |                   |          |              |                      |  |                                     |  |          |           |                   |                    |  |  |  |  |  |  |  |  |  |  |  |  |  |  |  |  |  |  |  |  |  |  |  |  |  |  |  |  |  |  |  |  |  |  |  |  |  |  |  |  |  |  |  |  |  |  |  |  |  |  |  |  |  |  |  |  |  |  |  |  |  |  |  |  |  |  |  |  |  |  |  |  |  |  |  |  |  |  |  |  |  |  |  |  |
| <table border="1" style="width:100%; border-collapse: collapse;"> <tr><td> </td><td> </td><td> </td><td> </td><td> </td><td> </td><td> </td><td> </td><td> </td><td> </td><td> </td><td> </td><td> </td><td> </td><td> </td><td> </td><td> </td><td> </td><td> </td><td> </td></tr> <tr><td> </td><td> </td><td> </td><td> </td><td> </td><td> </td><td> </td><td> </td><td> </td><td> </td><td> </td><td> </td><td> </td><td> </td><td> </td><td> </td><td> </td><td> </td><td> </td><td> </td></tr> <tr><td> </td><td> </td><td> </td><td> </td><td> </td><td> </td><td> </td><td> </td><td> </td><td> </td><td> </td><td> </td><td> </td><td> </td><td> </td><td> </td><td> </td><td> </td><td> </td><td> </td></tr> <tr><td> </td><td> </td><td> </td><td> </td><td> </td><td> </td><td> </td><td> </td><td> </td><td> </td><td> </td><td> </td><td> </td><td> </td><td> </td><td> </td><td> </td><td> </td><td> </td><td> </td></tr> </table> |                           |                   |         |            |                   |          |              |                      |  |                                     |  |          |           |                   |                    |  |  |  |  |  |  |  |  |  |  |  |  |  |  |  |  |  |  |  |  |  |  |  |  |  |  |  |  |  |  |  |  |  |  |  |  |  |  |  |  |  |  |  |  |  |  |  |  |  |  |  |  |  |  |  |  |  |  |  |  |  |  |  |  |  |  |  |  |  |  |  |  |  |  |  |  |  |  |  |  |  |  |  |  |
|  |                           |                   |         |            |                   |          |              |                      |  |                                     |  |          |           |                   |                    |  |  |  |  |  |  |  |  |  |  |  |  |  |  |  |  |  |  |  |  |  |  |  |  |  |  |  |  |  |  |  |  |  |  |  |  |  |  |  |  |  |  |  |  |  |  |  |  |  |  |  |  |  |  |  |  |  |  |  |  |  |  |  |  |  |  |  |  |  |  |  |  |  |  |  |  |  |  |  |  |  |  |  |  |
|  |                           |                   |         |            |                   |          |              |                      |  |                                     |  |          |           |                   |                    |  |  |  |  |  |  |  |  |  |  |  |  |  |  |  |  |  |  |  |  |  |  |  |  |  |  |  |  |  |  |  |  |  |  |  |  |  |  |  |  |  |  |  |  |  |  |  |  |  |  |  |  |  |  |  |  |  |  |  |  |  |  |  |  |  |  |  |  |  |  |  |  |  |  |  |  |  |  |  |  |  |  |  |  |
|  |                           |                   |         |            |                   |          |              |                      |  |                                     |  |          |           |                   |                    |  |  |  |  |  |  |  |  |  |  |  |  |  |  |  |  |  |  |  |  |  |  |  |  |  |  |  |  |  |  |  |  |  |  |  |  |  |  |  |  |  |  |  |  |  |  |  |  |  |  |  |  |  |  |  |  |  |  |  |  |  |  |  |  |  |  |  |  |  |  |  |  |  |  |  |  |  |  |  |  |  |  |  |  |
|  |                           |                   |         |            |                   |          |              |                      |  |                                     |  |          |           |                   |                    |  |  |  |  |  |  |  |  |  |  |  |  |  |  |  |  |  |  |  |  |  |  |  |  |  |  |  |  |  |  |  |  |  |  |  |  |  |  |  |  |  |  |  |  |  |  |  |  |  |  |  |  |  |  |  |  |  |  |  |  |  |  |  |  |  |  |  |  |  |  |  |  |  |  |  |  |  |  |  |  |  |  |  |  |
|  |                           | Niet gehecht vuil |         |            |                   |          | Gehecht vuil |                      |  |                                     |  | Diversen | Materiaal | Bijzonderheden    |                    |  |  |  |  |  |  |  |  |  |  |  |  |  |  |  |  |  |  |  |  |  |  |  |  |  |  |  |  |  |  |  |  |  |  |  |  |  |  |  |  |  |  |  |  |  |  |  |  |  |  |  |  |  |  |  |  |  |  |  |  |  |  |  |  |  |  |  |  |  |  |  |  |  |  |  |  |  |  |  |  |  |  |  |  |
|  |                           | Licht stof        |         | Dicht stof | Vlek/Vingertasten |          | Aan-slag     |                      |  |                                     |  |          |           |                   |                    |  |  |  |  |  |  |  |  |  |  |  |  |  |  |  |  |  |  |  |  |  |  |  |  |  |  |  |  |  |  |  |  |  |  |  |  |  |  |  |  |  |  |  |  |  |  |  |  |  |  |  |  |  |  |  |  |  |  |  |  |  |  |  |  |  |  |  |  |  |  |  |  |  |  |  |  |  |  |  |  |  |  |  |  |
|  |                           | Vuil              | Methode |            | Vuil              |          |              | Methode              |  |                                     |  |          |           |                   |                    |  |  |  |  |  |  |  |  |  |  |  |  |  |  |  |  |  |  |  |  |  |  |  |  |  |  |  |  |  |  |  |  |  |  |  |  |  |  |  |  |  |  |  |  |  |  |  |  |  |  |  |  |  |  |  |  |  |  |  |  |  |  |  |  |  |  |  |  |  |  |  |  |  |  |  |  |  |  |  |  |  |  |  |  |
| <input checked="" type="checkbox"/>  | Afvalbak / Prullenbak     |                   |         |            |                   |          |              |                      |  |                                     |  |          |           |                   |                    |  |  |  |  |  |  |  |  |  |  |  |  |  |  |  |  |  |  |  |  |  |  |  |  |  |  |  |  |  |  |  |  |  |  |  |  |  |  |  |  |  |  |  |  |  |  |  |  |  |  |  |  |  |  |  |  |  |  |  |  |  |  |  |  |  |  |  |  |  |  |  |  |  |  |  |  |  |  |  |  |  |  |  |  |
| <input checked="" type="checkbox"/>  | Armatuur / Bureaulamp     |                   |         |            |                   |          |              |                      |  |                                     |  |          |           |                   |                    |  |  |  |  |  |  |  |  |  |  |  |  |  |  |  |  |  |  |  |  |  |  |  |  |  |  |  |  |  |  |  |  |  |  |  |  |  |  |  |  |  |  |  |  |  |  |  |  |  |  |  |  |  |  |  |  |  |  |  |  |  |  |  |  |  |  |  |  |  |  |  |  |  |  |  |  |  |  |  |  |  |  |  |  |
|  | Bad binnenzijde           |                   |         |            |                   |          |              |                      |  |                                     |  |          |           |                   |                    |  |  |  |  |  |  |  |  |  |  |  |  |  |  |  |  |  |  |  |  |  |  |  |  |  |  |  |  |  |  |  |  |  |  |  |  |  |  |  |  |  |  |  |  |  |  |  |  |  |  |  |  |  |  |  |  |  |  |  |  |  |  |  |  |  |  |  |  |  |  |  |  |  |  |  |  |  |  |  |  |  |  |  |  |
|  | Bad buitenzijde           |                   |         |            |                   |          |              |                      |  |                                     |  |          |           |                   |                    |  |  |  |  |  |  |  |  |  |  |  |  |  |  |  |  |  |  |  |  |  |  |  |  |  |  |  |  |  |  |  |  |  |  |  |  |  |  |  |  |  |  |  |  |  |  |  |  |  |  |  |  |  |  |  |  |  |  |  |  |  |  |  |  |  |  |  |  |  |  |  |  |  |  |  |  |  |  |  |  |  |  |  |  |
|  | Badtrap                   |                   |         |            |                   |          |              |                      |  |                                     |  |          |           |                   |                    |  |  |  |  |  |  |  |  |  |  |  |  |  |  |  |  |  |  |  |  |  |  |  |  |  |  |  |  |  |  |  |  |  |  |  |  |  |  |  |  |  |  |  |  |  |  |  |  |  |  |  |  |  |  |  |  |  |  |  |  |  |  |  |  |  |  |  |  |  |  |  |  |  |  |  |  |  |  |  |  |  |  |  |  |
|  | Bank                      |                   |         |            |                   |          |              |                      |  |                                     |  |          |           |                   |                    |  |  |  |  |  |  |  |  |  |  |  |  |  |  |  |  |  |  |  |  |  |  |  |  |  |  |  |  |  |  |  |  |  |  |  |  |  |  |  |  |  |  |  |  |  |  |  |  |  |  |  |  |  |  |  |  |  |  |  |  |  |  |  |  |  |  |  |  |  |  |  |  |  |  |  |  |  |  |  |  |  |  |  |  |
|  | Balie, Bar                |                   |         |            |                   |          |              |                      |  |                                     |  |          |           |                   |                    |  |  |  |  |  |  |  |  |  |  |  |  |  |  |  |  |  |  |  |  |  |  |  |  |  |  |  |  |  |  |  |  |  |  |  |  |  |  |  |  |  |  |  |  |  |  |  |  |  |  |  |  |  |  |  |  |  |  |  |  |  |  |  |  |  |  |  |  |  |  |  |  |  |  |  |  |  |  |  |  |  |  |  |  |
|  | Bassinrand                |                   |         |            |                   |          |              |                      |  |                                     |  |          |           |                   |                    |  |  |  |  |  |  |  |  |  |  |  |  |  |  |  |  |  |  |  |  |  |  |  |  |  |  |  |  |  |  |  |  |  |  |  |  |  |  |  |  |  |  |  |  |  |  |  |  |  |  |  |  |  |  |  |  |  |  |  |  |  |  |  |  |  |  |  |  |  |  |  |  |  |  |  |  |  |  |  |  |  |  |  |  |
|  | Bedieningspaneel          |                   |         |            |                   |          |              |                      |  |                                     |  |          |           |                   |                    |  |  |  |  |  |  |  |  |  |  |  |  |  |  |  |  |  |  |  |  |  |  |  |  |  |  |  |  |  |  |  |  |  |  |  |  |  |  |  |  |  |  |  |  |  |  |  |  |  |  |  |  |  |  |  |  |  |  |  |  |  |  |  |  |  |  |  |  |  |  |  |  |  |  |  |  |  |  |  |  |  |  |  |  |
|  | Behandelbed               |                   |         |            |                   |          |              |                      |  |                                     |  |          |           |                   |                    |  |  |  |  |  |  |  |  |  |  |  |  |  |  |  |  |  |  |  |  |  |  |  |  |  |  |  |  |  |  |  |  |  |  |  |  |  |  |  |  |  |  |  |  |  |  |  |  |  |  |  |  |  |  |  |  |  |  |  |  |  |  |  |  |  |  |  |  |  |  |  |  |  |  |  |  |  |  |  |  |  |  |  |  |
| <input checked="" type="checkbox"/>  | Bijzettafel               |                   |         |            |                   |          |              |                      |  |                                     |  |          |           |                   |                    |  |  |  |  |  |  |  |  |  |  |  |  |  |  |  |  |  |  |  |  |  |  |  |  |  |  |  |  |  |  |  |  |  |  |  |  |  |  |  |  |  |  |  |  |  |  |  |  |  |  |  |  |  |  |  |  |  |  |  |  |  |  |  |  |  |  |  |  |  |  |  |  |  |  |  |  |  |  |  |  |  |  |  |  |
|  | Borstelhouder             |                   |         |            |                   |          |              |                      |  |                                     |  |          |           |                   |                    |  |  |  |  |  |  |  |  |  |  |  |  |  |  |  |  |  |  |  |  |  |  |  |  |  |  |  |  |  |  |  |  |  |  |  |  |  |  |  |  |  |  |  |  |  |  |  |  |  |  |  |  |  |  |  |  |  |  |  |  |  |  |  |  |  |  |  |  |  |  |  |  |  |  |  |  |  |  |  |  |  |  |  |  |
| <input checked="" type="checkbox"/>  | Brandblusapparaat         |                   |         |            | ///               |          |              |                      |  |                                     |  |          |           |                   |                    |  |  |  |  |  |  |  |  |  |  |  |  |  |  |  |  |  |  |  |  |  |  |  |  |  |  |  |  |  |  |  |  |  |  |  |  |  |  |  |  |  |  |  |  |  |  |  |  |  |  |  |  |  |  |  |  |  |  |  |  |  |  |  |  |  |  |  |  |  |  |  |  |  |  |  |  |  |  |  |  |  |  |  |  |
|  | Brilidekautomaat          |                   |         |            |                   |          |              |                      |  |                                     |  |          |           |                   |                    |  |  |  |  |  |  |  |  |  |  |  |  |  |  |  |  |  |  |  |  |  |  |  |  |  |  |  |  |  |  |  |  |  |  |  |  |  |  |  |  |  |  |  |  |  |  |  |  |  |  |  |  |  |  |  |  |  |  |  |  |  |  |  |  |  |  |  |  |  |  |  |  |  |  |  |  |  |  |  |  |  |  |  |  |
| <input checked="" type="checkbox"/>  | Bureau / Tafel            |                   |         |            |                   |          |              |                      |  |                                     |  |          |           |                   |                    |  |  |  |  |  |  |  |  |  |  |  |  |  |  |  |  |  |  |  |  |  |  |  |  |  |  |  |  |  |  |  |  |  |  |  |  |  |  |  |  |  |  |  |  |  |  |  |  |  |  |  |  |  |  |  |  |  |  |  |  |  |  |  |  |  |  |  |  |  |  |  |  |  |  |  |  |  |  |  |  |  |  |  |  |
| <input checked="" type="checkbox"/>  | Deur / Deurpost           |                   |         |            |                   |          |              |                      |  |                                     |  |          |           |                   |                    |  |  |  |  |  |  |  |  |  |  |  |  |  |  |  |  |  |  |  |  |  |  |  |  |  |  |  |  |  |  |  |  |  |  |  |  |  |  |  |  |  |  |  |  |  |  |  |  |  |  |  |  |  |  |  |  |  |  |  |  |  |  |  |  |  |  |  |  |  |  |  |  |  |  |  |  |  |  |  |  |  |  |  |  |
|  | Doorspoelinstallatie      |                   |         |            |                   |          |              |                      |  |                                     |  |          |           |                   |                    |  |  |  |  |  |  |  |  |  |  |  |  |  |  |  |  |  |  |  |  |  |  |  |  |  |  |  |  |  |  |  |  |  |  |  |  |  |  |  |  |  |  |  |  |  |  |  |  |  |  |  |  |  |  |  |  |  |  |  |  |  |  |  |  |  |  |  |  |  |  |  |  |  |  |  |  |  |  |  |  |  |  |  |  |
|  | <b>Douchevloer</b>        |                   |         |            |                   |          |              |                      |  |                                     |  |          |           |                   |                    |  |  |  |  |  |  |  |  |  |  |  |  |  |  |  |  |  |  |  |  |  |  |  |  |  |  |  |  |  |  |  |  |  |  |  |  |  |  |  |  |  |  |  |  |  |  |  |  |  |  |  |  |  |  |  |  |  |  |  |  |  |  |  |  |  |  |  |  |  |  |  |  |  |  |  |  |  |  |  |  |  |  |  |  |
|  | Douche-installatie        |                   |         |            |                   |          |              |                      |  |                                     |  |          |           |                   |                    |  |  |  |  |  |  |  |  |  |  |  |  |  |  |  |  |  |  |  |  |  |  |  |  |  |  |  |  |  |  |  |  |  |  |  |  |  |  |  |  |  |  |  |  |  |  |  |  |  |  |  |  |  |  |  |  |  |  |  |  |  |  |  |  |  |  |  |  |  |  |  |  |  |  |  |  |  |  |  |  |  |  |  |  |
|  | Douchewand                |                   |         |            |                   |          |              |                      |  |                                     |  |          |           |                   |                    |  |  |  |  |  |  |  |  |  |  |  |  |  |  |  |  |  |  |  |  |  |  |  |  |  |  |  |  |  |  |  |  |  |  |  |  |  |  |  |  |  |  |  |  |  |  |  |  |  |  |  |  |  |  |  |  |  |  |  |  |  |  |  |  |  |  |  |  |  |  |  |  |  |  |  |  |  |  |  |  |  |  |  |  |
|  | Gordijnrail               |                   |         |            |                   |          |              |                      |  |                                     |  |          |           |                   |                    |  |  |  |  |  |  |  |  |  |  |  |  |  |  |  |  |  |  |  |  |  |  |  |  |  |  |  |  |  |  |  |  |  |  |  |  |  |  |  |  |  |  |  |  |  |  |  |  |  |  |  |  |  |  |  |  |  |  |  |  |  |  |  |  |  |  |  |  |  |  |  |  |  |  |  |  |  |  |  |  |  |  |  |  |
|  | Handdoekautomaat          |                   |         |            |                   |          |              |                      |  |                                     |  |          |           |                   |                    |  |  |  |  |  |  |  |  |  |  |  |  |  |  |  |  |  |  |  |  |  |  |  |  |  |  |  |  |  |  |  |  |  |  |  |  |  |  |  |  |  |  |  |  |  |  |  |  |  |  |  |  |  |  |  |  |  |  |  |  |  |  |  |  |  |  |  |  |  |  |  |  |  |  |  |  |  |  |  |  |  |  |  |  |
|  | Hygiënezakhouder          |                   |         |            |                   |          |              |                      |  |                                     |  |          |           |                   |                    |  |  |  |  |  |  |  |  |  |  |  |  |  |  |  |  |  |  |  |  |  |  |  |  |  |  |  |  |  |  |  |  |  |  |  |  |  |  |  |  |  |  |  |  |  |  |  |  |  |  |  |  |  |  |  |  |  |  |  |  |  |  |  |  |  |  |  |  |  |  |  |  |  |  |  |  |  |  |  |  |  |  |  |  |
| <input checked="" type="checkbox"/>  | Kapstok                   |                   |         |            |                   |          |              |                      |  |                                     |  |          |           |                   |                    |  |  |  |  |  |  |  |  |  |  |  |  |  |  |  |  |  |  |  |  |  |  |  |  |  |  |  |  |  |  |  |  |  |  |  |  |  |  |  |  |  |  |  |  |  |  |  |  |  |  |  |  |  |  |  |  |  |  |  |  |  |  |  |  |  |  |  |  |  |  |  |  |  |  |  |  |  |  |  |  |  |  |  |  |
| <input checked="" type="checkbox"/>  | Kast (hoog)               |                   |         |            |                   |          | //           |                      |  |                                     |  |          |           |                   |                    |  |  |  |  |  |  |  |  |  |  |  |  |  |  |  |  |  |  |  |  |  |  |  |  |  |  |  |  |  |  |  |  |  |  |  |  |  |  |  |  |  |  |  |  |  |  |  |  |  |  |  |  |  |  |  |  |  |  |  |  |  |  |  |  |  |  |  |  |  |  |  |  |  |  |  |  |  |  |  |  |  |  |  |  |
|  | Kast (inbouw)             |                   |         |            |                   |          |              |                      |  |                                     |  |          |           |                   |                    |  |  |  |  |  |  |  |  |  |  |  |  |  |  |  |  |  |  |  |  |  |  |  |  |  |  |  |  |  |  |  |  |  |  |  |  |  |  |  |  |  |  |  |  |  |  |  |  |  |  |  |  |  |  |  |  |  |  |  |  |  |  |  |  |  |  |  |  |  |  |  |  |  |  |  |  |  |  |  |  |  |  |  |  |
| <input checked="" type="checkbox"/>  | Kast (laag)               |                   |         |            |                   |          |              |                      |  |                                     |  |          |           |                   |                    |  |  |  |  |  |  |  |  |  |  |  |  |  |  |  |  |  |  |  |  |  |  |  |  |  |  |  |  |  |  |  |  |  |  |  |  |  |  |  |  |  |  |  |  |  |  |  |  |  |  |  |  |  |  |  |  |  |  |  |  |  |  |  |  |  |  |  |  |  |  |  |  |  |  |  |  |  |  |  |  |  |  |  |  |
|  | Keukenblok /Aanrecht      |                   |         |            |                   |          |              |                      |  |                                     |  |          |           |                   |                    |  |  |  |  |  |  |  |  |  |  |  |  |  |  |  |  |  |  |  |  |  |  |  |  |  |  |  |  |  |  |  |  |  |  |  |  |  |  |  |  |  |  |  |  |  |  |  |  |  |  |  |  |  |  |  |  |  |  |  |  |  |  |  |  |  |  |  |  |  |  |  |  |  |  |  |  |  |  |  |  |  |  |  |  |
|  | Klimrek                   |                   |         |            |                   |          |              |                      |  |                                     |  |          |           |                   |                    |  |  |  |  |  |  |  |  |  |  |  |  |  |  |  |  |  |  |  |  |  |  |  |  |  |  |  |  |  |  |  |  |  |  |  |  |  |  |  |  |  |  |  |  |  |  |  |  |  |  |  |  |  |  |  |  |  |  |  |  |  |  |  |  |  |  |  |  |  |  |  |  |  |  |  |  |  |  |  |  |  |  |  |  |
|  | Koffie automaat           |                   |         |            |                   |          |              |                      |  |                                     |  |          |           |                   |                    |  |  |  |  |  |  |  |  |  |  |  |  |  |  |  |  |  |  |  |  |  |  |  |  |  |  |  |  |  |  |  |  |  |  |  |  |  |  |  |  |  |  |  |  |  |  |  |  |  |  |  |  |  |  |  |  |  |  |  |  |  |  |  |  |  |  |  |  |  |  |  |  |  |  |  |  |  |  |  |  |  |  |  |  |
|  | Leiding / Buis            |                   |         |            |                   |          |              |                      |  |                                     |  |          |           |                   |                    |  |  |  |  |  |  |  |  |  |  |  |  |  |  |  |  |  |  |  |  |  |  |  |  |  |  |  |  |  |  |  |  |  |  |  |  |  |  |  |  |  |  |  |  |  |  |  |  |  |  |  |  |  |  |  |  |  |  |  |  |  |  |  |  |  |  |  |  |  |  |  |  |  |  |  |  |  |  |  |  |  |  |  |  |
|  | Leuning                   |                   |         |            |                   |          |              |                      |  |                                     |  |          |           |                   |                    |  |  |  |  |  |  |  |  |  |  |  |  |  |  |  |  |  |  |  |  |  |  |  |  |  |  |  |  |  |  |  |  |  |  |  |  |  |  |  |  |  |  |  |  |  |  |  |  |  |  |  |  |  |  |  |  |  |  |  |  |  |  |  |  |  |  |  |  |  |  |  |  |  |  |  |  |  |  |  |  |  |  |  |  |
|  | Pedaalemmer               |                   |         |            |                   |          |              |                      |  |                                     |  |          |           |                   |                    |  |  |  |  |  |  |  |  |  |  |  |  |  |  |  |  |  |  |  |  |  |  |  |  |  |  |  |  |  |  |  |  |  |  |  |  |  |  |  |  |  |  |  |  |  |  |  |  |  |  |  |  |  |  |  |  |  |  |  |  |  |  |  |  |  |  |  |  |  |  |  |  |  |  |  |  |  |  |  |  |  |  |  |  |
|  | Planchet                  |                   |         |            |                   |          |              |                      |  |                                     |  |          |           |                   |                    |  |  |  |  |  |  |  |  |  |  |  |  |  |  |  |  |  |  |  |  |  |  |  |  |  |  |  |  |  |  |  |  |  |  |  |  |  |  |  |  |  |  |  |  |  |  |  |  |  |  |  |  |  |  |  |  |  |  |  |  |  |  |  |  |  |  |  |  |  |  |  |  |  |  |  |  |  |  |  |  |  |  |  |  |
|  | Plint / Kabelgoot         |                   |         |            |                   |          |              |                      |  |                                     |  |          |           |                   |                    |  |  |  |  |  |  |  |  |  |  |  |  |  |  |  |  |  |  |  |  |  |  |  |  |  |  |  |  |  |  |  |  |  |  |  |  |  |  |  |  |  |  |  |  |  |  |  |  |  |  |  |  |  |  |  |  |  |  |  |  |  |  |  |  |  |  |  |  |  |  |  |  |  |  |  |  |  |  |  |  |  |  |  |  |
| <input checked="" type="checkbox"/>  | Radiator / Convectorkast  |                   |         |            |                   |          |              |                      |  |                                     |  |          |           |                   |                    |  |  |  |  |  |  |  |  |  |  |  |  |  |  |  |  |  |  |  |  |  |  |  |  |  |  |  |  |  |  |  |  |  |  |  |  |  |  |  |  |  |  |  |  |  |  |  |  |  |  |  |  |  |  |  |  |  |  |  |  |  |  |  |  |  |  |  |  |  |  |  |  |  |  |  |  |  |  |  |  |  |  |  |  |
|  | Rand / Richel             |                   |         |            |                   |          |              |                      |  |                                     |  |          |           |                   |                    |  |  |  |  |  |  |  |  |  |  |  |  |  |  |  |  |  |  |  |  |  |  |  |  |  |  |  |  |  |  |  |  |  |  |  |  |  |  |  |  |  |  |  |  |  |  |  |  |  |  |  |  |  |  |  |  |  |  |  |  |  |  |  |  |  |  |  |  |  |  |  |  |  |  |  |  |  |  |  |  |  |  |  |  |
| <input checked="" type="checkbox"/>  | Schakelaar / Contactd.    |                   |         |            |                   |          |              |                      |  |                                     |  |          |           |                   |                    |  |  |  |  |  |  |  |  |  |  |  |  |  |  |  |  |  |  |  |  |  |  |  |  |  |  |  |  |  |  |  |  |  |  |  |  |  |  |  |  |  |  |  |  |  |  |  |  |  |  |  |  |  |  |  |  |  |  |  |  |  |  |  |  |  |  |  |  |  |  |  |  |  |  |  |  |  |  |  |  |  |  |  |  |
|  | Schoolbord                |                   |         |            |                   |          |              |                      |  |                                     |  |          |           |                   |                    |  |  |  |  |  |  |  |  |  |  |  |  |  |  |  |  |  |  |  |  |  |  |  |  |  |  |  |  |  |  |  |  |  |  |  |  |  |  |  |  |  |  |  |  |  |  |  |  |  |  |  |  |  |  |  |  |  |  |  |  |  |  |  |  |  |  |  |  |  |  |  |  |  |  |  |  |  |  |  |  |  |  |  |  |
|  | Spiegel                   |                   |         |            |                   |          |              |                      |  |                                     |  |          |           |                   |                    |  |  |  |  |  |  |  |  |  |  |  |  |  |  |  |  |  |  |  |  |  |  |  |  |  |  |  |  |  |  |  |  |  |  |  |  |  |  |  |  |  |  |  |  |  |  |  |  |  |  |  |  |  |  |  |  |  |  |  |  |  |  |  |  |  |  |  |  |  |  |  |  |  |  |  |  |  |  |  |  |  |  |  |  |
| <input checked="" type="checkbox"/>  | Stoel / Kruk              |                   |         |            |                   |          |              |                      |  |                                     |  |          |           |                   |                    |  |  |  |  |  |  |  |  |  |  |  |  |  |  |  |  |  |  |  |  |  |  |  |  |  |  |  |  |  |  |  |  |  |  |  |  |  |  |  |  |  |  |  |  |  |  |  |  |  |  |  |  |  |  |  |  |  |  |  |  |  |  |  |  |  |  |  |  |  |  |  |  |  |  |  |  |  |  |  |  |  |  |  |  |
| <input checked="" type="checkbox"/>  | Spinrag                   |                   |         |            |                   |          |              |                      |  |                                     |  |          |           |                   |                    |  |  |  |  |  |  |  |  |  |  |  |  |  |  |  |  |  |  |  |  |  |  |  |  |  |  |  |  |  |  |  |  |  |  |  |  |  |  |  |  |  |  |  |  |  |  |  |  |  |  |  |  |  |  |  |  |  |  |  |  |  |  |  |  |  |  |  |  |  |  |  |  |  |  |  |  |  |  |  |  |  |  |  |  |
| <input checked="" type="checkbox"/>  | Telefoon                  |                   |         |            |                   |          |              |                      |  |                                     |  |          |           |                   |                    |  |  |  |  |  |  |  |  |  |  |  |  |  |  |  |  |  |  |  |  |  |  |  |  |  |  |  |  |  |  |  |  |  |  |  |  |  |  |  |  |  |  |  |  |  |  |  |  |  |  |  |  |  |  |  |  |  |  |  |  |  |  |  |  |  |  |  |  |  |  |  |  |  |  |  |  |  |  |  |  |  |  |  |  |
|  | Toiletbril                |                   |         |            |                   |          |              |                      |  |                                     |  |          |           |                   |                    |  |  |  |  |  |  |  |  |  |  |  |  |  |  |  |  |  |  |  |  |  |  |  |  |  |  |  |  |  |  |  |  |  |  |  |  |  |  |  |  |  |  |  |  |  |  |  |  |  |  |  |  |  |  |  |  |  |  |  |  |  |  |  |  |  |  |  |  |  |  |  |  |  |  |  |  |  |  |  |  |  |  |  |  |
|  | Toiletpapierautomaat      |                   |         |            |                   |          |              |                      |  |                                     |  |          |           |                   |                    |  |  |  |  |  |  |  |  |  |  |  |  |  |  |  |  |  |  |  |  |  |  |  |  |  |  |  |  |  |  |  |  |  |  |  |  |  |  |  |  |  |  |  |  |  |  |  |  |  |  |  |  |  |  |  |  |  |  |  |  |  |  |  |  |  |  |  |  |  |  |  |  |  |  |  |  |  |  |  |  |  |  |  |  |
|  | <b>Toiletpot / Siokop</b> |                   |         |            |                   |          |              |                      |  |                                     |  |          |           |                   |                    |  |  |  |  |  |  |  |  |  |  |  |  |  |  |  |  |  |  |  |  |  |  |  |  |  |  |  |  |  |  |  |  |  |  |  |  |  |  |  |  |  |  |  |  |  |  |  |  |  |  |  |  |  |  |  |  |  |  |  |  |  |  |  |  |  |  |  |  |  |  |  |  |  |  |  |  |  |  |  |  |  |  |  |  |
|  | Toiletrolhouder           |                   |         |            |                   |          |              |                      |  |                                     |  |          |           |                   |                    |  |  |  |  |  |  |  |  |  |  |  |  |  |  |  |  |  |  |  |  |  |  |  |  |  |  |  |  |  |  |  |  |  |  |  |  |  |  |  |  |  |  |  |  |  |  |  |  |  |  |  |  |  |  |  |  |  |  |  |  |  |  |  |  |  |  |  |  |  |  |  |  |  |  |  |  |  |  |  |  |  |  |  |  |
|  | Tussen-/schaamschot       |                   |         |            |                   |          |              |                      |  |                                     |  |          |           |                   |                    |  |  |  |  |  |  |  |  |  |  |  |  |  |  |  |  |  |  |  |  |  |  |  |  |  |  |  |  |  |  |  |  |  |  |  |  |  |  |  |  |  |  |  |  |  |  |  |  |  |  |  |  |  |  |  |  |  |  |  |  |  |  |  |  |  |  |  |  |  |  |  |  |  |  |  |  |  |  |  |  |  |  |  |  |
|  | <b>Urinoir</b>            |                   |         |            |                   |          |              |                      |  |                                     |  |          |           |                   |                    |  |  |  |  |  |  |  |  |  |  |  |  |  |  |  |  |  |  |  |  |  |  |  |  |  |  |  |  |  |  |  |  |  |  |  |  |  |  |  |  |  |  |  |  |  |  |  |  |  |  |  |  |  |  |  |  |  |  |  |  |  |  |  |  |  |  |  |  |  |  |  |  |  |  |  |  |  |  |  |  |  |  |  |  |
| <input checked="" type="checkbox"/>  | Vensterbank               |                   |         |            | /                 |          |              |                      |  |                                     |  |          |           |                   |                    |  |  |  |  |  |  |  |  |  |  |  |  |  |  |  |  |  |  |  |  |  |  |  |  |  |  |  |  |  |  |  |  |  |  |  |  |  |  |  |  |  |  |  |  |  |  |  |  |  |  |  |  |  |  |  |  |  |  |  |  |  |  |  |  |  |  |  |  |  |  |  |  |  |  |  |  |  |  |  |  |  |  |  |  |
|  | Verbandautomaat           |                   |         |            |                   |          |              |                      |  |                                     |  |          |           |                   |                    |  |  |  |  |  |  |  |  |  |  |  |  |  |  |  |  |  |  |  |  |  |  |  |  |  |  |  |  |  |  |  |  |  |  |  |  |  |  |  |  |  |  |  |  |  |  |  |  |  |  |  |  |  |  |  |  |  |  |  |  |  |  |  |  |  |  |  |  |  |  |  |  |  |  |  |  |  |  |  |  |  |  |  |  |
| <input checked="" type="checkbox"/>  | <b>Vloer / Trap</b>       |                   |         |            |                   |          |              |                      |  |                                     |  |          |           |                   |                    |  |  |  |  |  |  |  |  |  |  |  |  |  |  |  |  |  |  |  |  |  |  |  |  |  |  |  |  |  |  |  |  |  |  |  |  |  |  |  |  |  |  |  |  |  |  |  |  |  |  |  |  |  |  |  |  |  |  |  |  |  |  |  |  |  |  |  |  |  |  |  |  |  |  |  |  |  |  |  |  |  |  |  |  |
|  | Wand                      |                   |         |            |                   |          |              |                      |  |                                     |  |          |           |                   |                    |  |  |  |  |  |  |  |  |  |  |  |  |  |  |  |  |  |  |  |  |  |  |  |  |  |  |  |  |  |  |  |  |  |  |  |  |  |  |  |  |  |  |  |  |  |  |  |  |  |  |  |  |  |  |  |  |  |  |  |  |  |  |  |  |  |  |  |  |  |  |  |  |  |  |  |  |  |  |  |  |  |  |  |  |
|  | <b>Wastafel</b>           |                   |         |            |                   |          |              |                      |  |                                     |  |          |           |                   |                    |  |  |  |  |  |  |  |  |  |  |  |  |  |  |  |  |  |  |  |  |  |  |  |  |  |  |  |  |  |  |  |  |  |  |  |  |  |  |  |  |  |  |  |  |  |  |  |  |  |  |  |  |  |  |  |  |  |  |  |  |  |  |  |  |  |  |  |  |  |  |  |  |  |  |  |  |  |  |  |  |  |  |  |  |
|  | Zeepdispenser             |                   |         |            |                   |          |              |                      |  |                                     |  |          |           |                   |                    |  |  |  |  |  |  |  |  |  |  |  |  |  |  |  |  |  |  |  |  |  |  |  |  |  |  |  |  |  |  |  |  |  |  |  |  |  |  |  |  |  |  |  |  |  |  |  |  |  |  |  |  |  |  |  |  |  |  |  |  |  |  |  |  |  |  |  |  |  |  |  |  |  |  |  |  |  |  |  |  |  |  |  |  |
| <b>Totaal:</b>   |                           |                   |         |            |                   |          |              |                      |  |                                     |  |          |           |                   |                    |  |  |  |  |  |  |  |  |  |  |  |  |  |  |  |  |  |  |  |  |  |  |  |  |  |  |  |  |  |  |  |  |  |  |  |  |  |  |  |  |  |  |  |  |  |  |  |  |  |  |  |  |  |  |  |  |  |  |  |  |  |  |  |  |  |  |  |  |  |  |  |  |  |  |  |  |  |  |  |  |  |  |  |  |
| Opmerkingen:   |                           |                   |         |            |                   |          |              |                      |  |                                     |  |          |           |                   |                    |  |  |  |  |  |  |  |  |  |  |  |  |  |  |  |  |  |  |  |  |  |  |  |  |  |  |  |  |  |  |  |  |  |  |  |  |  |  |  |  |  |  |  |  |  |  |  |  |  |  |  |  |  |  |  |  |  |  |  |  |  |  |  |  |  |  |  |  |  |  |  |  |  |  |  |  |  |  |  |  |  |  |  |  |

| VSR KMS               |   |          |                      |  |  | Lijst van elementen bij de categorie: <b>Sanitair</b> |  |                      |
|-----------------------|---|----------|----------------------|--|--|---|--|----------------------|
| Gebouw                | <b>Het Examen Kantoor</b>   |          |                      |  |  | Volgnummer  | <b>1</b>                                 |                      |
| Datum                 | <b>10-04-14</b>   | Tijdstip | <b>10.00 - 11.30</b> |  |  | KMS-Versie  | <b>3</b>                                 | Vul in:<br>1, 2 of 3 |
| Inspecteur            |   |          |                      |  |  |   |  |                      |
| te inventariseren (x) | <b>Ruimtecodes steekproef - Methode B incl. de SE's - Methode C/D incl. eventuele splitsing</b> |          |                      |  |  |   | <b>SE's</b>                              |                      |
|                       |   |          |                      |  |  |   | Ruimten                                  | (b)                  |
|                       |   |          |                      |  |  |   |  |                      |
|                       |   |          |                      |  |  |   |  |                      |
|                       |   |          |                      |  |  |   | <b>Totaal</b>                            | (c)                  |
|                       | <b>Element:</b>   |          |                      |  |  | <b>Totaal:</b>  | <b>Aantal:</b>                           |                      |
| X                     | Afvalbak / Prullenbak   |          |                      |  |  |   | ### ## III                               |                      |
| X                     | Armatuur / Bureaulamp   |          |                      |  |  |   | ### ## III                               |                      |
|                       | Bad binnenzijde / Badgarnituur  |          |                      |  |  |   |  |                      |
|                       | Bad buitenzijde   |          |                      |  |  |   |  |                      |
|                       | Badtrap   |          |                      |  |  |   |  |                      |
|                       | Bank  |          |                      |  |  |   |  |                      |
|                       | Balie, Bar  |          |                      |  |  |   |  |                      |
|                       | Bassinrand  |          |                      |  |  |   |  |                      |
|                       | Bedieningspaneel  |          |                      |  |  |   |  |                      |
|                       | Behandelbed   |          |                      |  |  |   |  |                      |
|                       | Bijzettafel   |          |                      |  |  |   |  |                      |
| X                     | Borstelhouder   |          |                      |  |  |   | ### ## ## ## ## ## III                   |                      |
|                       | Brandblusapparaat   |          |                      |  |  |   |  |                      |
|                       | Brijdekautomaat   |          |                      |  |  |   |  |                      |
|                       | Bureau / Tafel  |          |                      |  |  |   |  |                      |
| X                     | Deur / Deurpost   |          |                      |  |  |   | ### ## ## ## ## ## ## ## ## III          |                      |
| X                     | Doorspoelinstallatie  |          |                      |  |  |   | ### ## ## ## ## ## ## I                  |                      |
|                       | <b>Douche- / Natte vloer</b>  |          |                      |  |  |   |  |                      |
|                       | Douche-installatie  |          |                      |  |  |   |  |                      |
|                       | Douchewand  |          |                      |  |  |   |  |                      |
|                       | Gordijnrail   |          |                      |  |  |   |  |                      |
| X                     | Handdoekhouder / Handdoekautomaat   |          |                      |  |  |   | ### ## III                               |                      |
| X                     | Hygienezakhouder  |          |                      |  |  |   | ### III                                  |                      |
|                       | Kapstok   |          |                      |  |  |   |  |                      |
|                       | Kast (hoog)   |          |                      |  |  |   |  |                      |
|                       | Kast (inbouw)   |          |                      |  |  |   |  |                      |
|                       | Kast (laag)   |          |                      |  |  |   |  |                      |
|                       | Keukenblok / Aanrecht   |          |                      |  |  |   |  |                      |
|                       | Klimrek   |          |                      |  |  |   |  |                      |
|                       | Koffie automaat   |          |                      |  |  |   |  |                      |
|                       | Leiding / Buis  |          |                      |  |  |   | III                                      |                      |
| X                     | Leuning   |          |                      |  |  |   | II                                       |                      |
| X                     | Pedaalemmer   |          |                      |  |  |   | ### ## ##                                |                      |
| X                     | Planchet  |          |                      |  |  |   | ### ## III                               |                      |
| X                     | Plint / Kabelgoot   |          |                      |  |  |   | III                                      |                      |
| X                     | Radiator / Convectorkast  |          |                      |  |  |   | ### ## III                               |                      |
| X                     | Rand / Richel   |          |                      |  |  |   | II                                       |                      |
| X                     | Schakelaar / Contactdoos  | (1)      |                      |  |  |   | ### ## III                               |                      |
|                       | Schoolbord  |          |                      |  |  |   |  |                      |
| X                     | Spiegel   |          |                      |  |  |   | ### ## III                               |                      |
|                       | Stoel / Kruk  |          |                      |  |  |   |  |                      |
|                       | Telefoon  |          |                      |  |  |   |  |                      |
| X                     | Toiletbril  |          |                      |  |  |   | ### ## ## ## ## ## III                   |                      |
|                       | Toiletpapierautomaat  |          |                      |  |  |   |  |                      |
| X                     | <b>Toiletpot / Slokop</b>   |          |                      |  |  |   | ### ## ## ## ## ## III                   |                      |
| X                     | Toiletrolhouder   |          |                      |  |  |   | ### ## ## ## ## ## III                   |                      |
| X                     | Tussenschot / Schaamschot   |          |                      |  |  |   | ### I                                    |                      |
| X                     | <b>Urinoir</b>  |          |                      |  |  |   | ### ## II                                |                      |
| X                     | Vensterbank   |          |                      |  |  |   | III                                      |                      |
|                       | Verbandautomaat   |          |                      |  |  |   |  |                      |
| X                     | <b>Vloer / Trap</b>   |          |                      |  |  |   | ### ## ## ## ## ## ## ## ## ## ## ## III |                      |
| X                     | Wand  |          |                      |  |  |   | ### ## ## ## ## ## ## ## ## ## ## ## III |                      |
| X                     | <b>Wastafel</b>   |          |                      |  |  |   | ### ## III                               |                      |
| X                     | Zeepe dispenser   |          |                      |  |  |   | ### ## III                               |                      |
|                       |   |          |                      |  |  |   |  |                      |
|                       |   |          |                      |  |  |   |  |                      |
|                       |   |          |                      |  |  |   |  |                      |
|                       |   |          |                      |  |  |   |  |                      |
|                       | <b>Totaal elementen</b>   |          |                      |  |  |   | <b>(e)</b>                               |                      |

(1) Bij bureaulampen 2-maal het aantal vloeren

**VSR KMS** Inventarisatie overzicht per categorie: **Sanitair**

|            |                    |            |   |
|------------|--------------------|------------|---|
| Gebouw     | Het Examen Kantoor |            |   |
| Datum      | 10-04-14           | KMS-Versie | 3 |
| Inspecteur | Vul in: 1, 2 of 3  |            |   |

|                        |        |
|------------------------|--------|
| Inventarisatie methode | Type = |
|------------------------|--------|

A = 100% --- B = deelsteekproef --- C = selecte steekproef --- D = aselechte steekproef

**Totaal aantal ruimten:** (zie: lijst van ruimten)

**Aantal ruimten in de inventarisatie**  
 Methode A: het totale aantal ruimten = a, **OF**   
 Methode B/C/D: het aantal ruimten in de inventarisatie (zie: lijst van elementen)

**Aantal SE's in de inventarisatie** (zie: lijst van elementen)

**Totaal aantal steekprofeenheden:**  
 Methode A / B het totale aantal SE's **OF** (zie: lijst van ruimten)   
 Methode C / D SE's in inventarisatie x  $\frac{\text{Totaal aantal ruimten}}{\text{Ruimten in steekproef}}$   $\frac{c \times a}{b}$

**Aantal elementen in de inventarisatie:** (zie: lijst van elementen)

**MAF-waarde:**  $\frac{\text{aantal elementen in inventarisatie}}{\text{aantal SE's in inventarisatie}}$   $\frac{e}{c}$   (1)

**AQL (Acceptance Quality Limit)**

**Aantal geplande controles per jaar** (i.v.m. het grijze gebied)  (2)

**Minimaal aantal te controleren Beoordelingseenheden (SE's):** m n s  (3)

m.b.v. totaal aantal SE's (d) opzoeken in de steekproefgrootte-tabel

Alleen methode C en D:

**Gemiddeld aantal beoordelingseenheden per ruimte:**  
 $\frac{\text{totaal aantal SE's}}{\text{totaal aantal ruimten}}$   $\frac{d}{a}$   (3)

**Minimaal aantal te controleren ruimten:**  
 $\frac{\text{Steekproefgrootte in SE's}}{\text{aantal SE's per ruimte}}$   $\frac{i}{j}$  m n s  (4)

De steekproefgrootten (m / n / s : verminderd, normaal, verscherpt) voor de controle, uitgedrukt in minimum aantal te controleren SE's (i) en eventueel ook in minimum aantal ruimten (k) is nu bekend.

(1) Statistisch afronden. Groter of gelijk aan 3,50 op hele getallen, kleiner tot op één cijfer achter de komma.  
 (2) Bij schema's met een lage keuringsfrequentie moet men buiten het grijze gebied blijven.  
 (3) Afronden tot twee cijfers achter de komma  
 (4) Afronden naar boven op hele getallen

**(hoort bij opdracht 13: controle - Sanitair)**

Begin bij getal 93 in het vierkantje!

Tabel van willekeurige getallen

Annex E

|                |                |                |                |                       |
|----------------|----------------|----------------|----------------|-----------------------|
| 99 55 96 83 31 | 62 53 52 41 70 | 69 77 71 28 30 | 74 81 97 81 42 | 43 86 07 28 34        |
| 77 51 30 38 20 | 86 83 42 99 01 | 68 41 48 27 74 | 51 90 31 39 80 | 72 29 35 55 07        |
| 19 50 23 71 74 | 69 97 92 02 88 | 55 21 02 97 73 | 74 28 77 52 51 | 65 34 46 74 15        |
| 21 81 85 93 13 | 93 27 88 17 57 | 05 63 67 31 56 | 07 08 28 50 46 | 31 85 33 84 52        |
| 51 47 46 64 99 | 68 10 72 36 21 | 94 04 99 13 45 | 42 83 60 91 91 | 08 00 74 54 49        |
| 33 71 34 80 07 | 93 58 47 28 69 | 51 92 66 47 21 | 58 30 32 98 22 | 93 17 49 39 72        |
| 85 27 48 68 93 | 11 30 32 92 70 | 28 83 43 41 37 | 78 51 59 04 00 | 71 14 84 36 43        |
| 84 13 38 96 40 | 44 03 55 21 66 | 73 85 27 00 91 | 61 22 26 05 61 | 62 32 71 84 23        |
| 65 73 21 62 34 | 17 39 59 61 31 | 10 12 39 16 22 | 85 49 65 75 60 | 81 60 41 88 80        |
| 56 13 85 68 06 | 87 64 88 52 61 | 34 31 36 58 61 | 45 87 52 10 69 | 85 64 44 72 77        |
| 38 00 10 21 76 | 81 71 91 17 11 | 71 60 29 29 37 | 74 21 96 49 49 | 65 58 44 96 98        |
| 37 40 29 63 97 | 01 30 47 75 86 | 56 27 11 00 86 | 47 32 46 26 02 | 40 03 03 74 38        |
| 97 12 45 03 48 | 87 08 33 14 17 | 21 81 53 92 50 | 75 23 76 20 47 | 15 50 12 95 78        |
| 21 63 34 11 62 | 47 14 33 40 72 | 64 63 88 59 02 | 49 13 90 64 41 | 03 85 65 45 52        |
| 73 13 54 27 42 | 95 71 90 90 35 | 85 79 47 42 96 | 08 78 98 81 56 | 64 69 11 92 02        |
| 07 63 87 79 29 | 03 06 11 80 72 | 96 20 74 41 56 | 23 82 19 95 38 | 04 71 36 69 94        |
| 60 52 88 34 41 | 07 95 41 98 14 | 59 17 52 06 95 | 05 53 35 21 39 | 61 21 20 64 55        |
| 83 59 63 56 55 | 06 95 89 29 83 | 05 12 80 97 19 | 77 43 35 37 83 | 92 30 15 04 98        |
| 10 85 06 27 46 | 99 59 91 05 07 | 13 49 90 63 19 | 53 07 57 18 39 | 06 41 01 93 62        |
| 39 82 09 89 52 | 43 62 26 31 47 | 64 42 18 08 14 | 43 80 00 93 51 | 31 02 47 31 67        |
| 59 58 00 64 78 | 75 56 97 88 00 | 88 83 55 44 86 | 23 76 80 61 56 | 04 11 10 84 08        |
| 38 50 80 73 41 | 23 79 34 87 63 | 90 82 29 70 22 | 17 71 90 42 07 | 95 95 44 99 53        |
| 30 69 27 06 68 | 94 68 81 61 27 | 56 19 68 00 91 | 82 06 76 34 00 | 05 46 26 92 00        |
| 65 44 39 56 59 | 18 28 82 74 37 | 49 63 22 40 41 | 08 33 76 56 76 | 96 29 99 08 36        |
| 27 26 75 02 64 | 13 19 27 22 94 | 07 47 74 46 06 | 17 98 54 89 11 | 97 34 13 03 58        |
| 91 30 90 70 69 | 91 19 07 22 42 | 10 36 69 95 37 | 28 28 82 53 57 | <b>93</b> 28 97 66 62 |
| 68 43 49 46 88 | 84 47 31 36 22 | 62 12 09 84 08 | 12 84 38 25 90 | 09 81 59 31 46        |
| 48 90 81 58 77 | 54 74 52 45 91 | 35 70 00 47 54 | 83 82 45 26 92 | 54 13 05 51 60        |
| 06 91 34 51 97 | 42 67 27 86 01 | 11 88 30 95 28 | 63 01 19 89 01 | 14 97 44 03 44        |
| 10 45 51 60 19 | 14 21 03 37 12 | 91 34 23 78 21 | 88 32 58 08 51 | 43 66 77 08 83        |
| 12 88 39 73 43 | 65 02 76 11 84 | 04 28 50 13 92 | 17 97 41 50 77 | 90 71 22 67 69        |
| 21 77 83 09 76 | 38 80 73 69 61 | 31 64 94 20 96 | 63 28 10 20 23 | 08 81 64 74 49        |
| 19 52 35 95 15 | 65 12 25 96 59 | 86 28 36 82 58 | 69 57 21 37 98 | 16 43 59 15 29        |
| 67 24 55 26 70 | 35 58 31 65 63 | 79 24 68 66 86 | 76 46 33 42 22 | 26 65 59 08 02        |
| 60 58 44 73 77 | 07 50 03 79 92 | 45 13 42 65 29 | 26 76 08 36 37 | 41 32 64 43 44        |
| 53 85 34 13 77 | 36 06 69 48 50 | 58 83 87 38 59 | 49 36 47 33 31 | 96 24 04 36 42        |
| 24 63 73 87 36 | 74 38 48 93 42 | 52 62 30 79 92 | 12 36 91 86 01 | 03 74 28 38 73        |
| 83 08 01 24 51 | 38 99 22 28 15 | 07 75 95 17 77 | 97 37 72 75 85 | 51 97 23 78 67        |
| 16 44 42 43 34 | 36 15 19 90 73 | 27 49 37 09 39 | 85 13 03 25 52 | 54 84 65 47 59        |
| 60 79 01 81 57 | 57 17 86 57 62 | 11 16 17 85 76 | 45 81 95 29 79 | 65 13 00 48 30        |

**VSR KMS** **Controleformulier bij de categorie:**

|            |                   |          |          |                      |     |  |  |
|------------|-------------------|----------|----------|----------------------|-----|--|--|
| Gebouw     | Het Examenkantoor |          |          |                      |     | Volgnummer                                     |  |
| Inspecteur |                   |          |          |                      |     | Minimale steekproefgrootte: KMS-Versie (1/2/3) |  |
| Datum      | 27-05-14          | Tijdstip | 7.00 uur | in SE's              | (i) | AQL %  |  |
| Goedkeur ≤ |                   |          | goedkeur | in kamers            | (k) | MAF-Waarde (f)                                 |  |
| Fouten     |                   |          | afkeur   | (Bij methode C en D) |     | Steekproefgrootte                              |  |

|                                |  |  |  |  |  |  |  |  |  |  |  |  |  |  |
|--------------------------------|--|--|--|--|--|--|--|--|--|--|--|--|--|--|
| Ruimtecodes en aantallen SE's. |  |  |  |  |  |  |  |  |  |  |  |  |  |  |
|                                |  |  |  |  |  |  |  |  |  |  |  |  |  |  |
|                                |  |  |  |  |  |  |  |  |  |  |  |  |  |  |
|                                |  |  |  |  |  |  |  |  |  |  |  |  |  |  |
|                                |  |  |  |  |  |  |  |  |  |  |  |  |  |  |
|                                |  |  |  |  |  |  |  |  |  |  |  |  |  |  |
|                                |  |  |  |  |  |  |  |  |  |  |  |  |  |  |
|                                |  |  |  |  |  |  |  |  |  |  |  |  |  |  |

|   | Niet gehecht vuil |         |            |                   | Gehecht vuil |          |  | Diversen | Materiaal | Bijzonderheden |
|---|-------------------|---------|------------|-------------------|--------------|----------|--|----------|-----------|----------------|
|   | Licht stof        |         | Dicht stof | Vlek/Vingertasten |              | Aan-slag |  |          |           |                |
|   | Vuil              | Methode |            | Vuil              | Methode      |          |  |          |           |                |
| <input checked="" type="checkbox"/> Afvalbak / Prullenbak     |                   |         |            |                   |              |          |  |          |           |                |
| <input checked="" type="checkbox"/> Armatuur / Bureaulamp     |                   |         |            |                   |              |          |  |          |           |                |
| Bad binnenzijde   |                   |         |            |                   |              |          |  |          |           |                |
| Bad buitenzijde   |                   |         |            |                   |              |          |  |          |           |                |
| Badtrap   |                   |         |            |                   |              |          |  |          |           |                |
| Bank  |                   |         |            |                   |              |          |  |          |           |                |
| Balie, Bar  |                   |         |            |                   |              |          |  |          |           |                |
| Bassinrand  |                   |         |            |                   |              |          |  |          |           |                |
| Bedieningspaneel  |                   |         |            |                   |              |          |  |          |           |                |
| Behandelbed   |                   |         |            |                   |              |          |  |          |           |                |
| Bijzettafel   |                   |         |            |                   |              |          |  |          |           |                |
| <input checked="" type="checkbox"/> Borstelhouder             |                   |         |            |                   |              |          |  |          |           |                |
| Brandblusapparaat   |                   |         |            |                   |              |          |  |          |           |                |
| Brildekautomaat   |                   |         |            |                   |              |          |  |          |           |                |
| Bureau / Tafel  |                   |         |            |                   |              |          |  |          |           |                |
| <input checked="" type="checkbox"/> Deur / Deurpost           |                   |         |            |                   |              |          |  |          |           |                |
| <input checked="" type="checkbox"/> Doorspoelinstallatie      |                   |         |            |                   |              |          |  |          |           |                |
| <b>Douchevloer</b>  |                   |         |            |                   |              |          |  |          |           |                |
| Douche-installatie  |                   |         |            |                   |              |          |  |          |           |                |
| Douchewand  |                   |         |            |                   |              |          |  |          |           |                |
| Gordijnrail   |                   |         |            |                   |              |          |  |          |           |                |
| <input checked="" type="checkbox"/> Handdoekautomaat          |                   |         |            |                   |              |          |  |          |           |                |
| <input checked="" type="checkbox"/> Hygiënezakhouder          |                   |         |            |                   |              |          |  |          |           |                |
| Kast (hoog)   |                   |         |            |                   |              |          |  |          |           |                |
| Kast (hoog)   |                   |         |            |                   |              |          |  |          |           |                |
| Kast (inbouw)   |                   |         |            |                   |              |          |  |          |           |                |
| Kast (laag)   |                   |         |            |                   |              |          |  |          |           |                |
| Keukenblok /Aanrecht  |                   |         |            |                   |              |          |  |          |           |                |
| Klimrek   |                   |         |            |                   |              |          |  |          |           |                |
| Koffie automaat   |                   |         |            |                   |              |          |  |          |           |                |
| <input checked="" type="checkbox"/> Leiding / Buis            |                   |         |            |                   |              |          |  |          |           |                |
| <input checked="" type="checkbox"/> Leuning                   |                   |         |            |                   |              |          |  |          |           |                |
| <input checked="" type="checkbox"/> Pedaalemmer               |                   |         |            |                   |              |          |  |          |           |                |
| <input checked="" type="checkbox"/> Planchet                  |                   |         |            |                   |              |          |  |          |           |                |
| <input checked="" type="checkbox"/> Plint / Kabelgoot         |                   |         |            |                   |              |          |  |          |           |                |
| <input checked="" type="checkbox"/> Radiator / Convectorkast  |                   |         |            |                   |              |          |  |          |           |                |
| Rand / Richel   |                   |         |            |                   |              |          |  |          |           |                |
| <input checked="" type="checkbox"/> Schakelaar / Contactd.    |                   |         |            |                   |              |          |  |          |           |                |
| Schoolbord  |                   |         |            |                   |              |          |  |          |           |                |
| <input checked="" type="checkbox"/> Spiegel                   |                   |         |            |                   |              | //       |  |          |           |                |
| Stoel / Kruk  |                   |         |            |                   |              |          |  |          |           |                |
| Spinrag   |                   |         |            |                   |              |          |  |          |           |                |
| <input checked="" type="checkbox"/> Telefoon                  |                   |         |            |                   |              |          |  |          |           |                |
| Toiletbril  |                   |         |            |                   |              |          |  |          |           |                |
| <input checked="" type="checkbox"/> Toiletpapierautomaat      |                   |         |            |                   |              |          |  |          |           |                |
| <input checked="" type="checkbox"/> <b>Toiletpot / Slokop</b> |                   |         |            |                   |              |          |  |          |           |                |
| <input checked="" type="checkbox"/> Toiletrolhouder           |                   |         |            |                   |              |          |  |          |           |                |
| <input checked="" type="checkbox"/> Tussen-/schaamschot       |                   |         |            |                   |              | //       |  |          |           |                |
| <input checked="" type="checkbox"/> <b>Urinoir</b>            |                   |         |            |                   |              |          |  |          |           |                |
| Vensterbank   |                   |         |            |                   |              |          |  |          |           |                |
| <input checked="" type="checkbox"/> Verbandautomaat           |                   |         |            |                   |              |          |  |          |           |                |
| <input checked="" type="checkbox"/> <b>Vloer / Trap</b>       |                   |         |            |                   |              | //       |  |          |           |                |
| <input checked="" type="checkbox"/> Wand                      |                   |         |            |                   |              |          |  |          |           |                |
| <input checked="" type="checkbox"/> <b>Wastafel</b>           |                   |         |            |                   |              |          |  |          |           |                |
| Zeepdispenser   |                   |         |            |                   |              |          |  |          |           |                |
|   |                   |         |            |                   |              |          |  |          |           |                |
|   |                   |         |            |                   |              |          |  |          |           |                |
| <b>Totaal:</b>  |                   |         |            |                   |              |          |  |          |           |                |

Opmerkingen: